

# TOWER UNIT 3 & 4 DRAWERS

## (400 & 600mm wide)

### Assembly Instructions

#### CONTENTS:

- A** 1x Top panel
- B** 1x Side panel (left)
- C** 1x Side panel (right)
- D** 5x Shelves  
(4x for 4 drawers)
- E** 1x Plinth panel
- F** Soft close drawer runners  
3 Drawer Unit  
• 3x left, 3x right  
4 Drawer Unit  
• 4x left, 4x right
- G** Soft close clips  
3 Drawer Unit  
• 3x left, 3x right  
4 Drawer Unit  
• 4x left, 4x right
- H** Drawer backs  
3 Drawer Unit  
• x3  
4 Drawer Unit  
• x4
- I** Drawer sides (left)  
3 Drawer Unit  
• 3x left  
4 Drawer Unit  
• 4x left
- J** Drawer sides (right)  
3 Drawer Unit  
• 3x  
4 Drawer Unit  
• 4x
- K** Drawer bases  
3 Drawer Unit  
• x3  
4 Drawer Unit  
• x4
- L** Drawer fronts  
3 Drawer Unit  
• x3  
4 Drawer Unit  
• x4
- M** Drawer handles  
3 Drawer Unit  
• x3  
4 Drawer Unit  
• x4

#### TOWER UNIT PACK

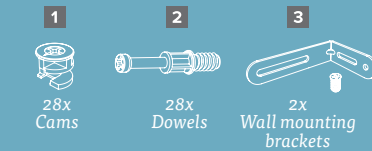

#### DRAWER PACK

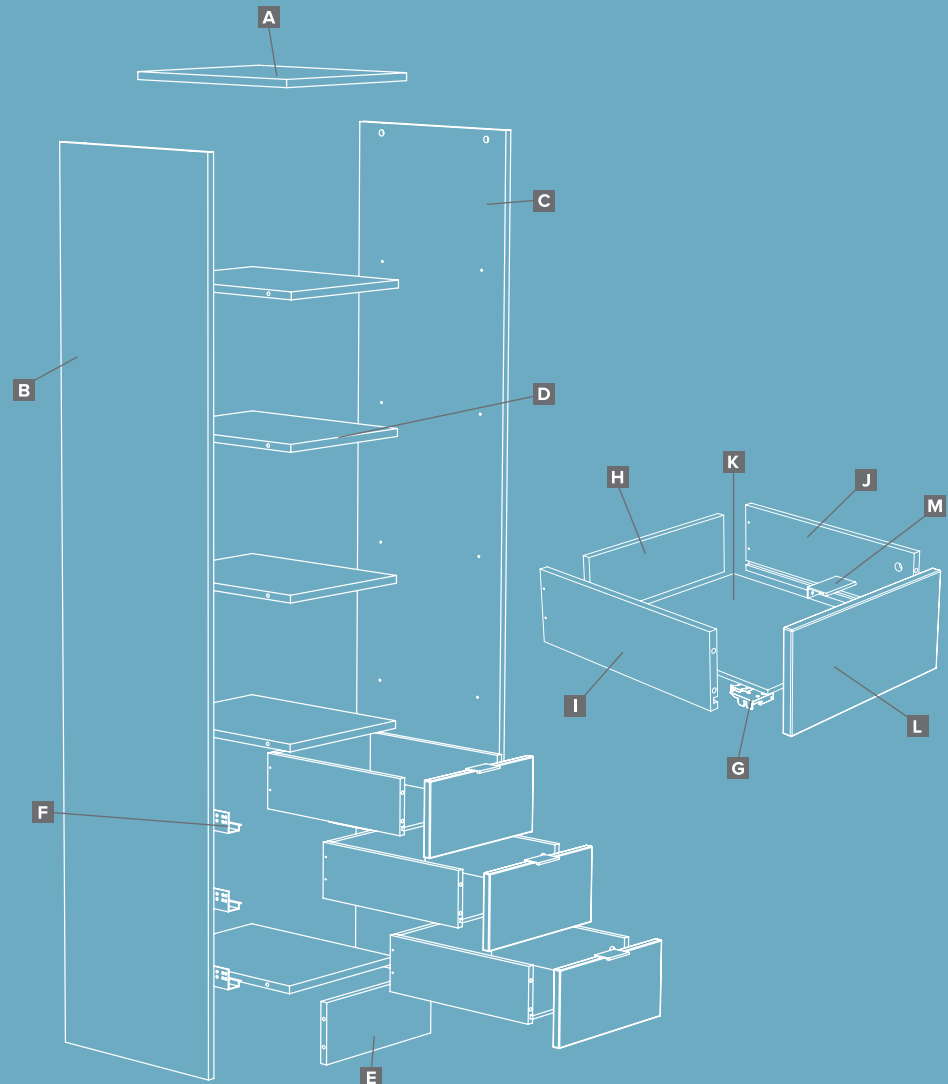
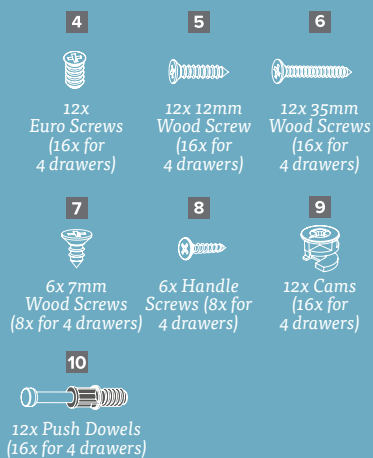

#### RECOMMENDED:

- TOOLS: Screwdriver
- TWO PERSON BUILD



**We recommend you use the Wall Mounting Brackets provided to fix the Tower Unit to a wall (where possible). This will prevent the unit being pulled over. Use suitable fixings.**

**spaceslide®**  
we make room

V1

PLEASE NOTE THE 3 AND 4 DRAWER TOWER UNIT ARE THE SAME IN CONSTRUCTION. WE HAVE USED THE 3 DRAWER TOWER UNIT AS AN EXAMPLE.

Note: B panel shown

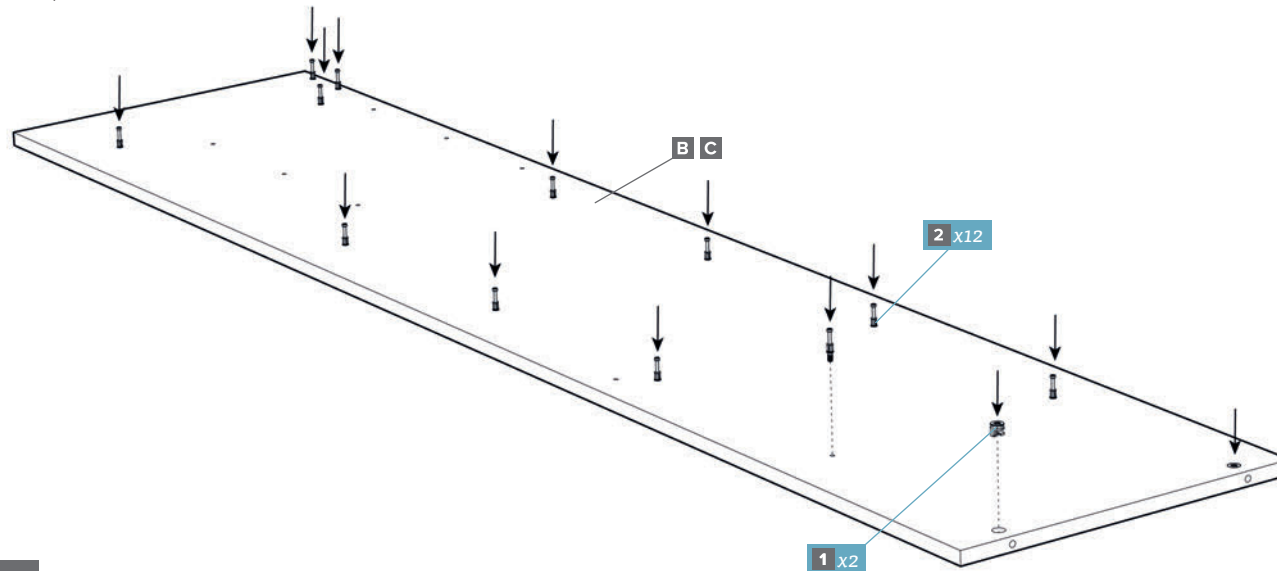

**1** Lay panels (B & C) on a flat surface. Fit cams & dowels to both panels.

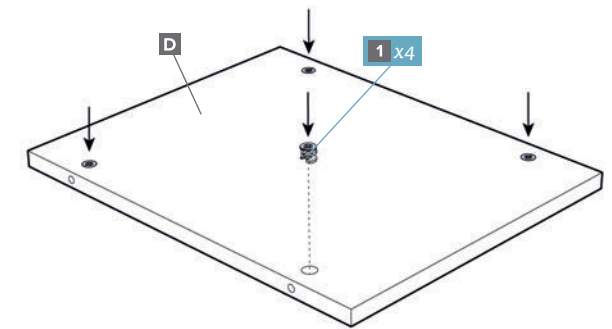

**2** Apply to all panels (x5 - 3 drawers, x4 - 4 drawers).

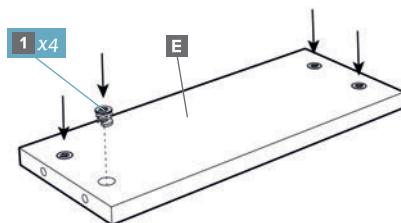

**3**

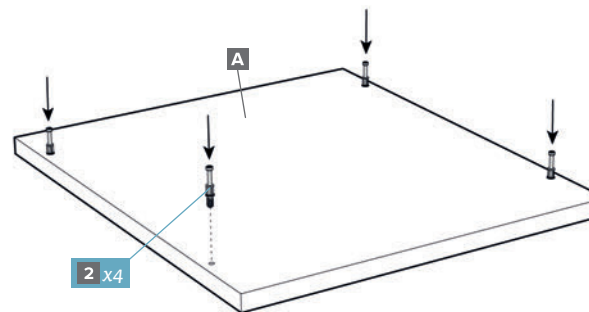

**4**

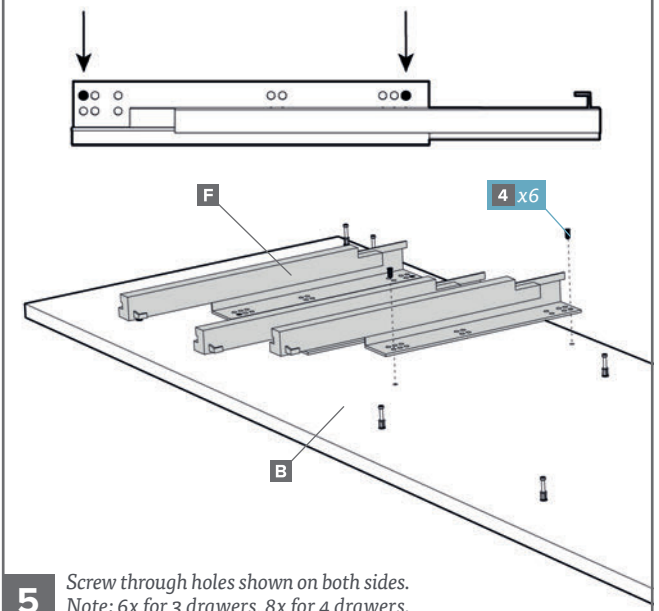

**5** Screw through holes shown on both sides.  
Note: 6x for 3 drawers, 8x for 4 drawers.

PLEASE NOTE THE 3 AND 4 DRAWER TOWER UNIT ARE THE SAME IN CONSTRUCTION. WE HAVE USED THE 3 DRAWER TOWER UNIT AS AN EXAMPLE.

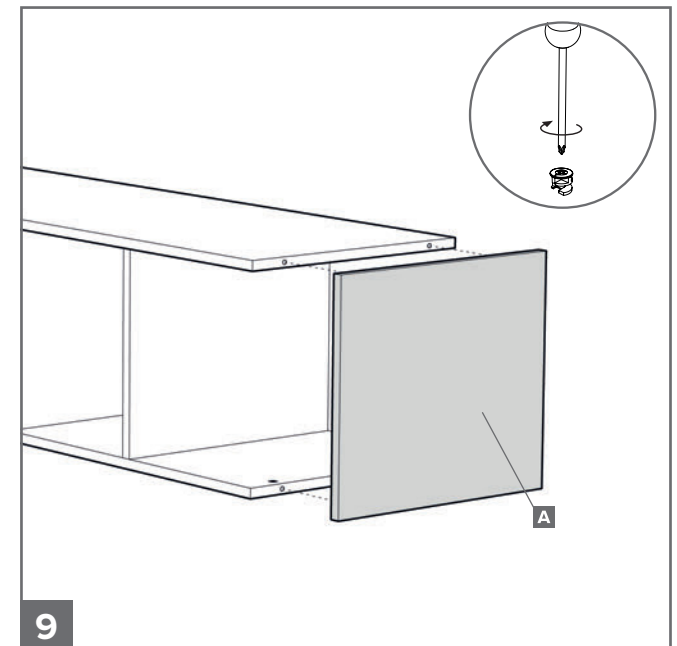
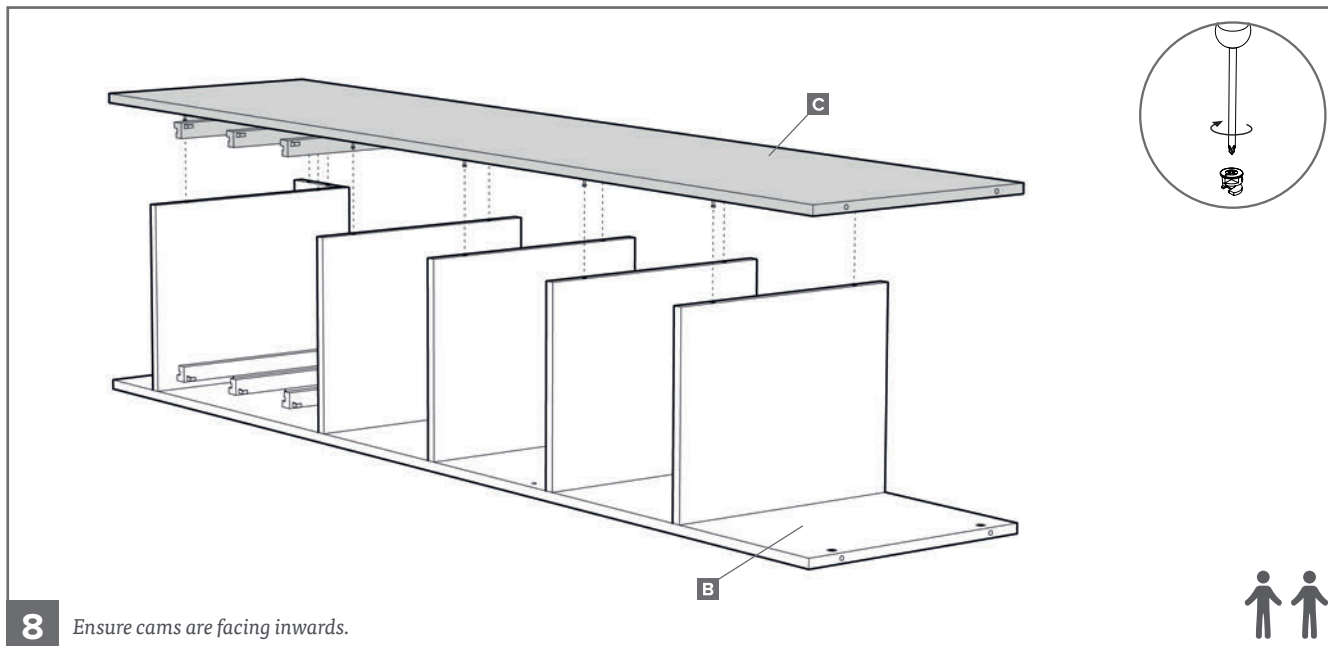
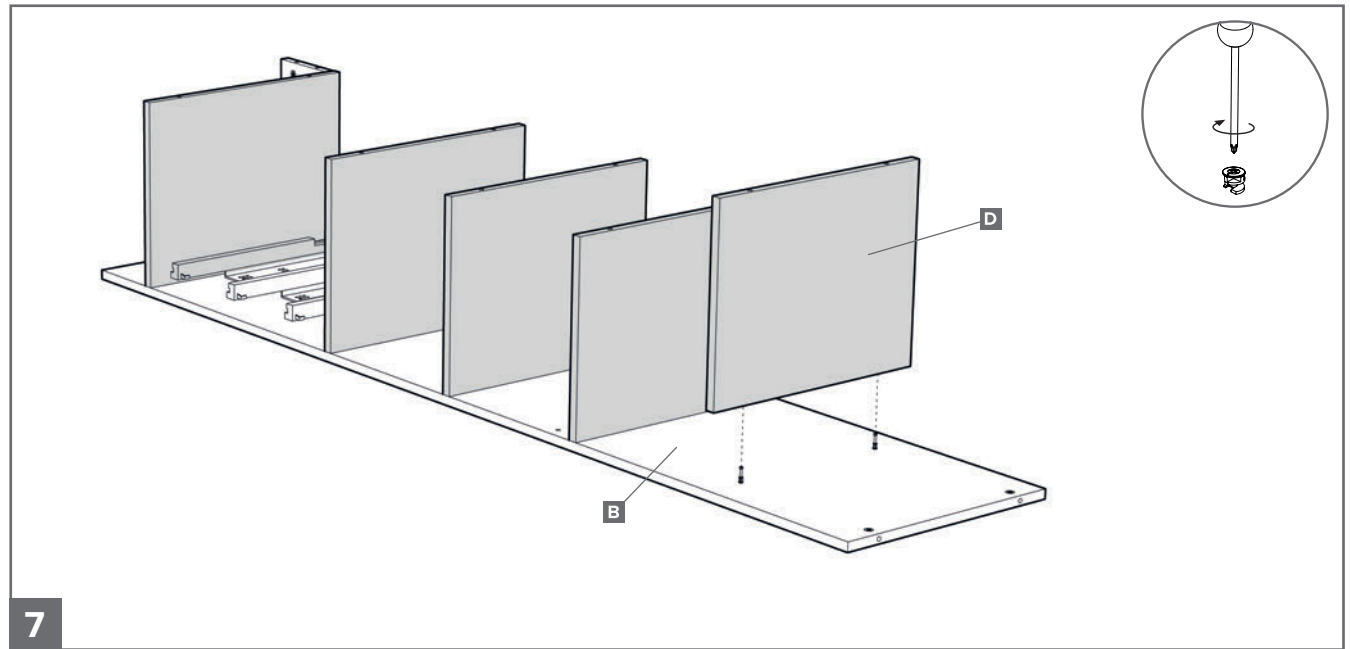
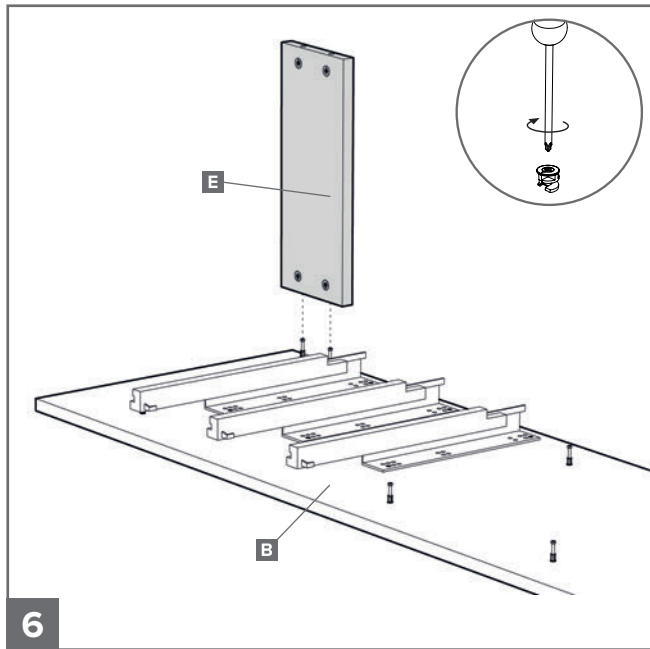

PLEASE NOTE THE 3 AND 4 DRAWER TOWER UNIT ARE THE SAME IN CONSTRUCTION. WE HAVE USED THE 3 DRAWER TOWER UNIT AS AN EXAMPLE.

## MAKING THE DRAWERS

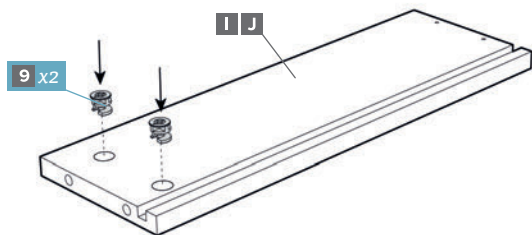

**10** (Repeat on all drawer sides).

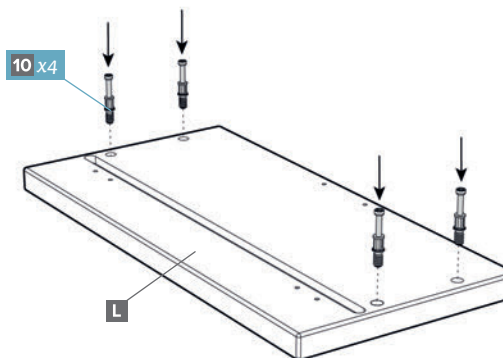

**11** (Repeat on all drawer fronts).

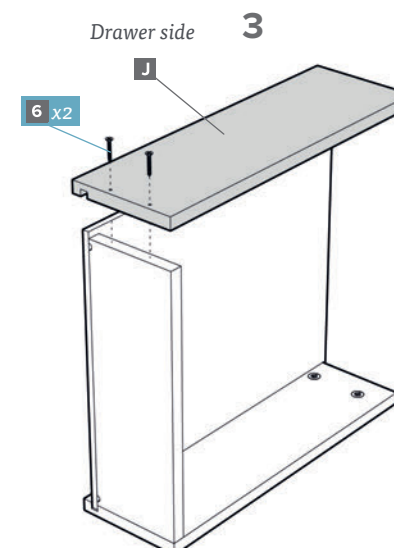
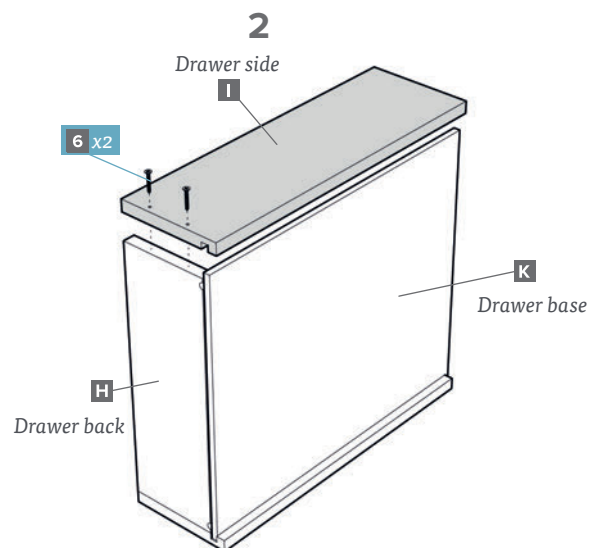
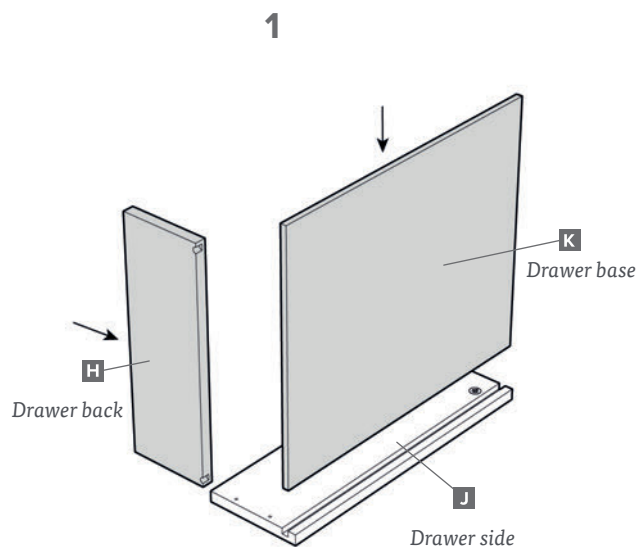

**12** 1- Lay drawer side (J) on a flat surface, insert the base (K) into the groove then hold the back panel (H) in-place. 2- Place the other drawer side (I) over the base and screw into the back panel (H). 3- Turn the drawer around and screw in panel (J) . (Repeat on all drawers).

PLEASE NOTE THE 3 AND 4 DRAWER TOWER UNIT ARE THE SAME IN CONSTRUCTION. WE HAVE USED THE 3 DRAWER TOWER UNIT AS AN EXAMPLE.

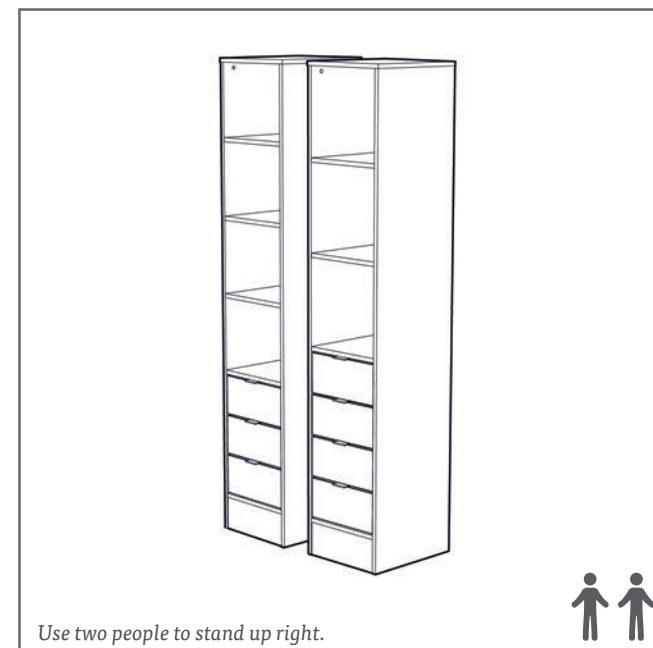
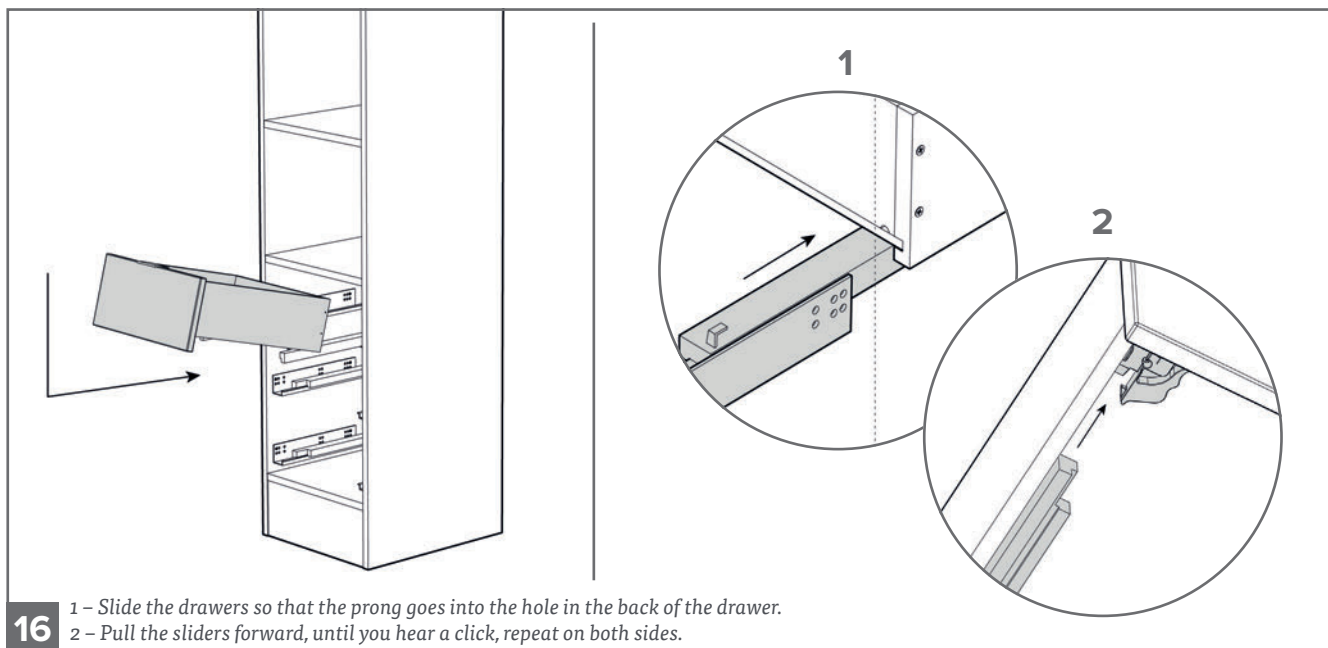
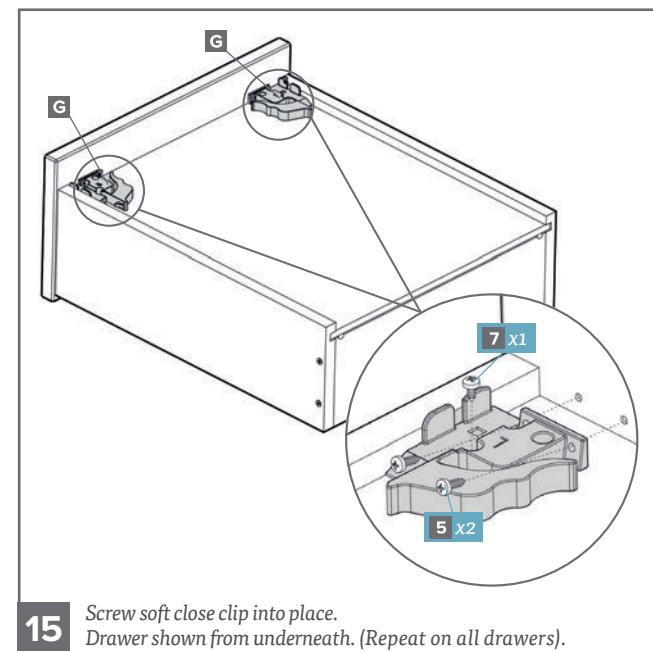
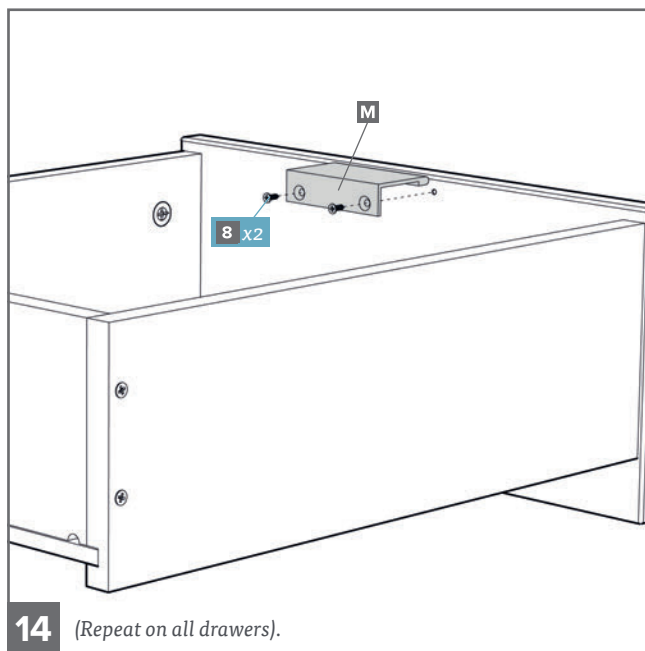
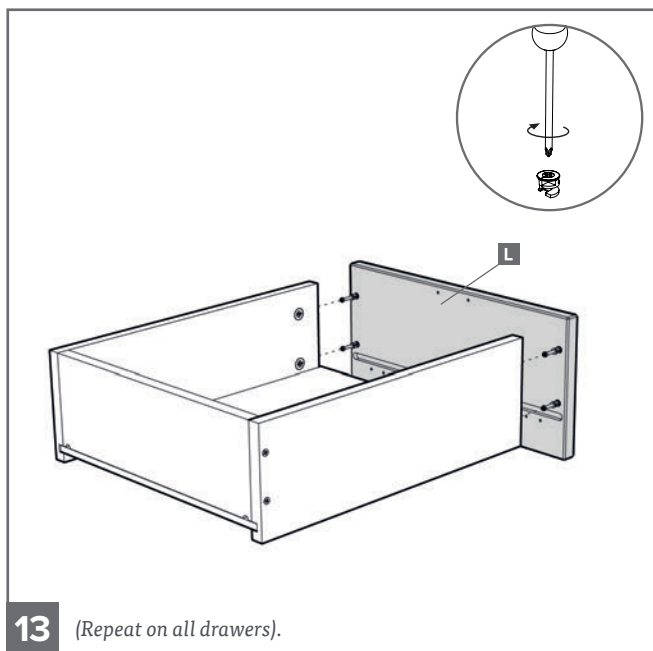

PLEASE NOTE THE 3 AND 4 DRAWER TOWER UNIT ARE THE SAME IN CONSTRUCTION. WE HAVE USED THE 3 DRAWER TOWER UNIT AS AN EXAMPLE.



## WALL MOUNTING BRACKETS

*We recommend you use the Wall Mounting Brackets provided to fix the Tower Unit to a wall (where possible). This will prevent the unit being pulled over. Use suitable fixings.*

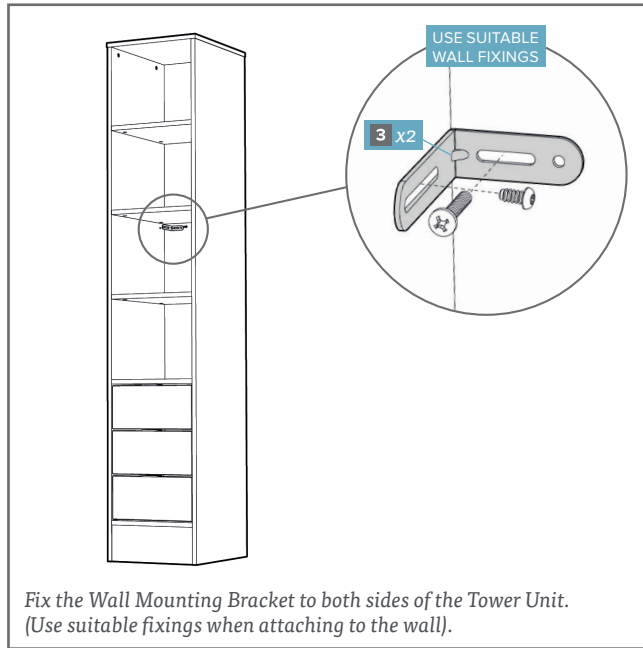



# HOW TO FIT TOWER UNIT

## Assembly Instructions

### TOOLS REQUIRED:

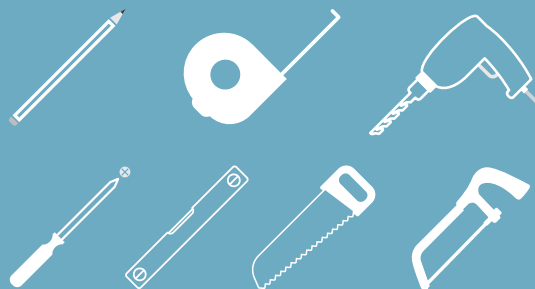

Please check your opening for any hidden electrical wires and water pipes before / screwing.



Screws not supplied. Use suitable screws and plugs.

**spaceslide®**  
we make room

V1

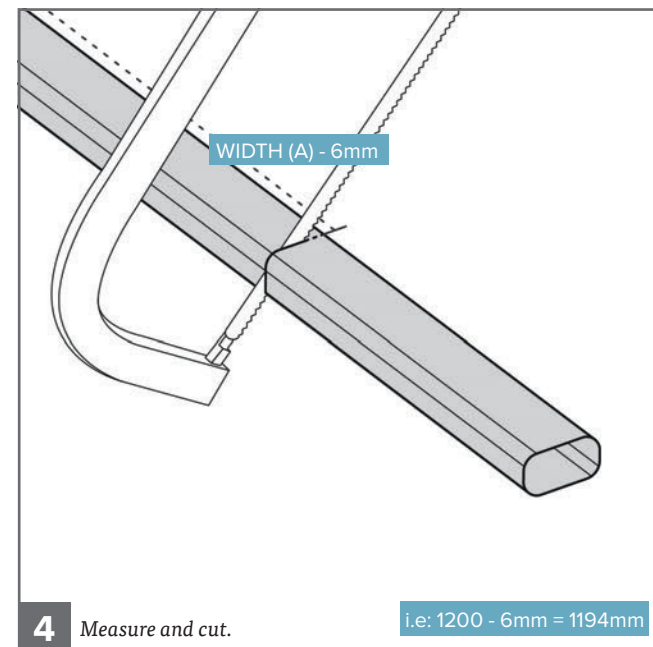
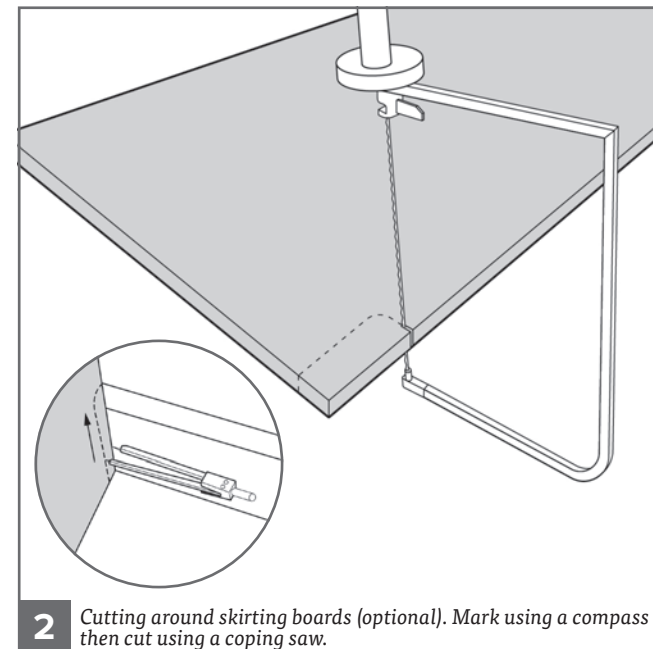
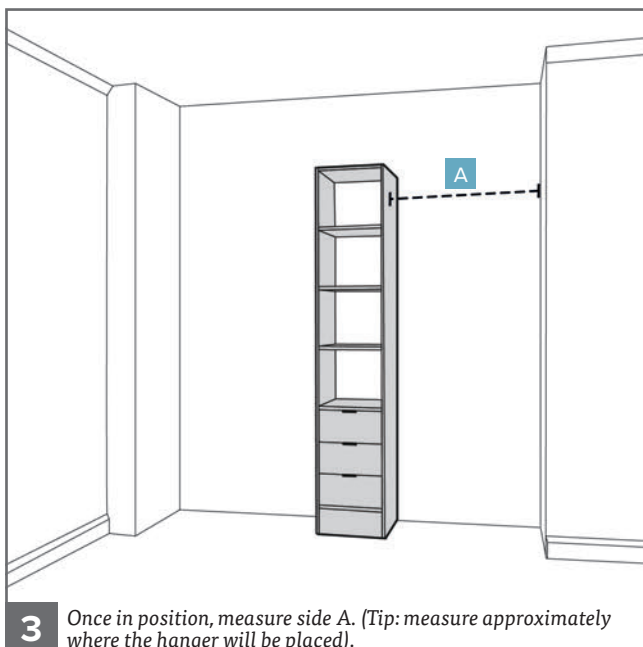
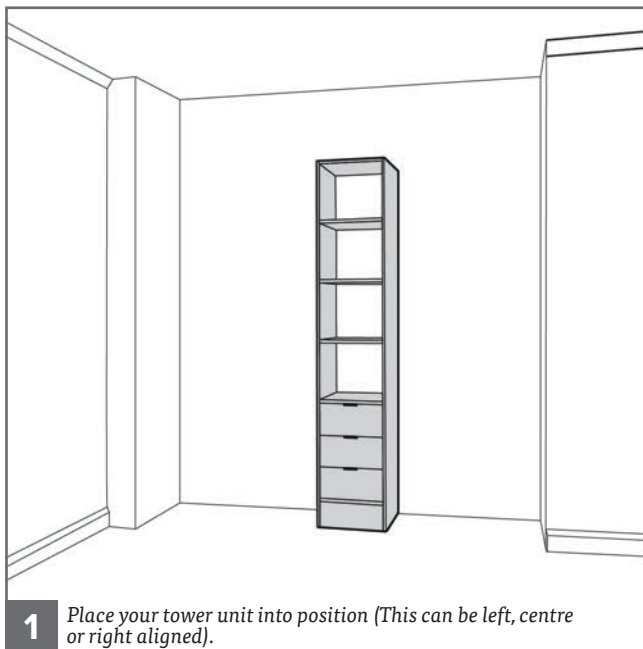

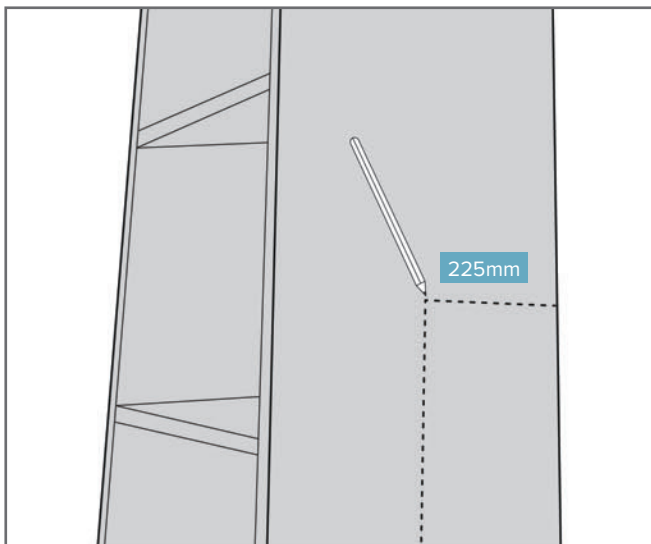

**5** Mark the position of the hanger bar. By measuring in 225mm to the centre of the tower unit.

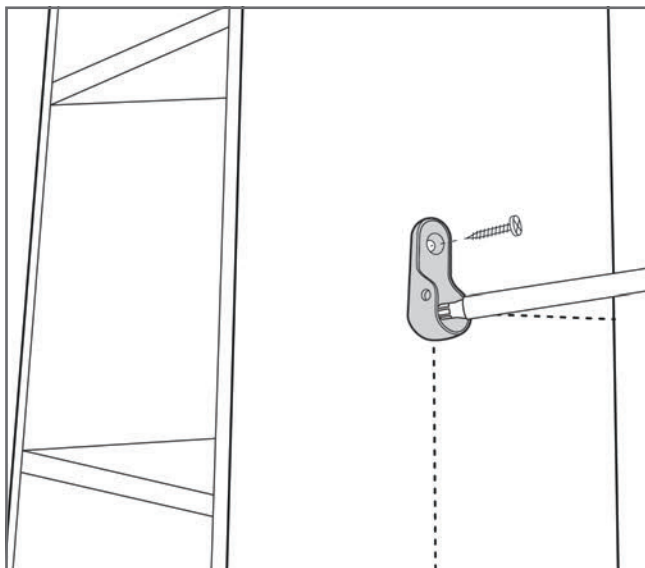

**6** Fix first bracket through both holes. (We recommend 16mm screws).

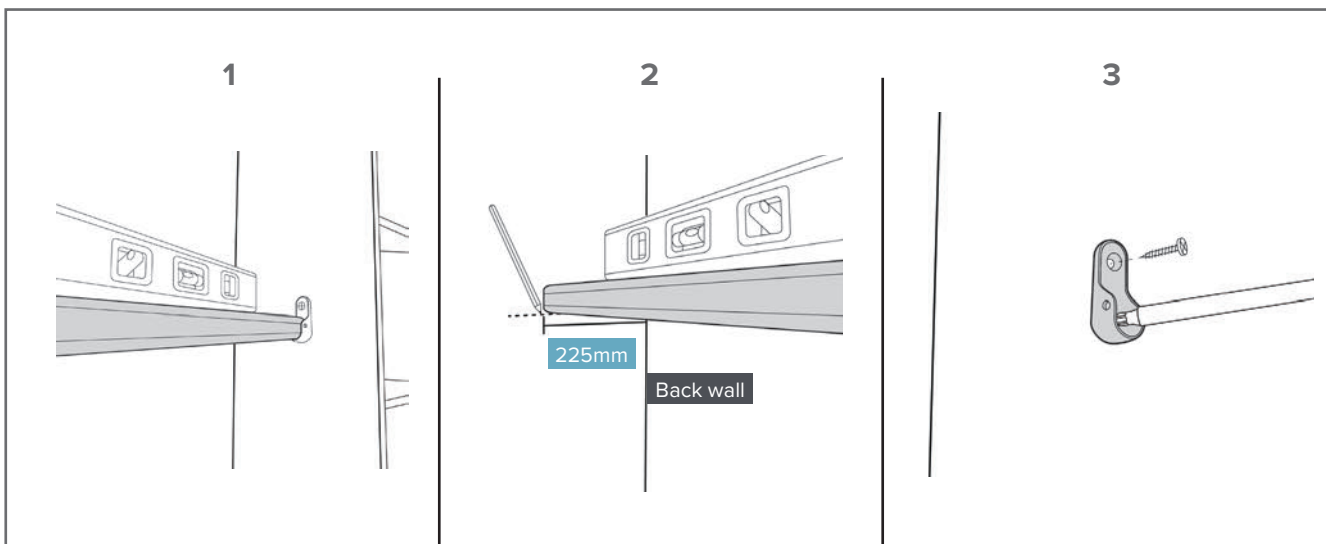

**7** Fitting the second hanger bar.  
1- Place hanger bar into first bracket and level up. 2-Make sure to mark position on the side wall 225mm from the back wall.  
3-Then fix into position.

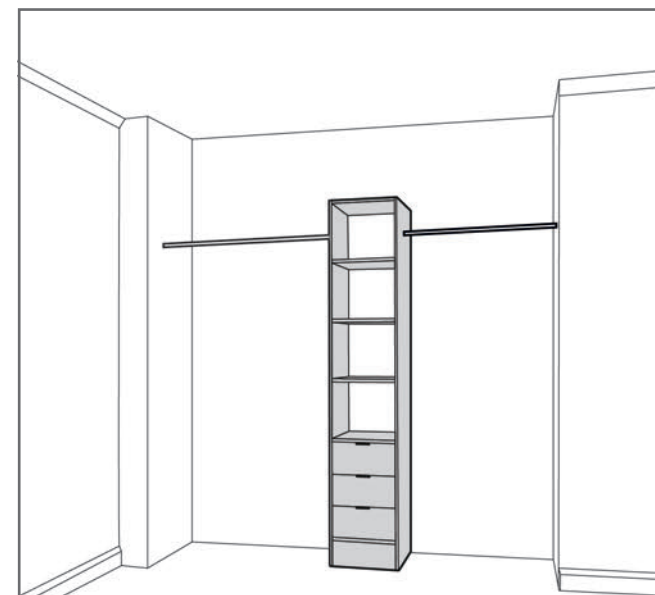

**8** Repeat 3-7 for remaining hanger bars.