

HOW TO FIT PREMIER STORAGE

Assembly Instructions

TOOLS REQUIRED:

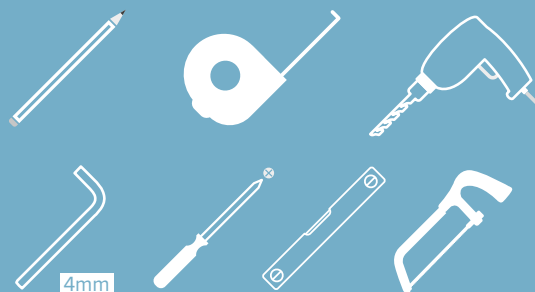

Please check your opening for any hidden electrical wires and water pipes before / screwing.



Screws not supplied.
Use suitable screws
and plugs.

spaceslide®
we make room

V1

FIXING STANCHIONS

You can use the 'How to Measure Up' guide to ensure your space has been measured correctly.

(In this example we have used Storage kit 14. 1000mm section on the left, 500mm mid-section followed by another 1000mm section on the right).

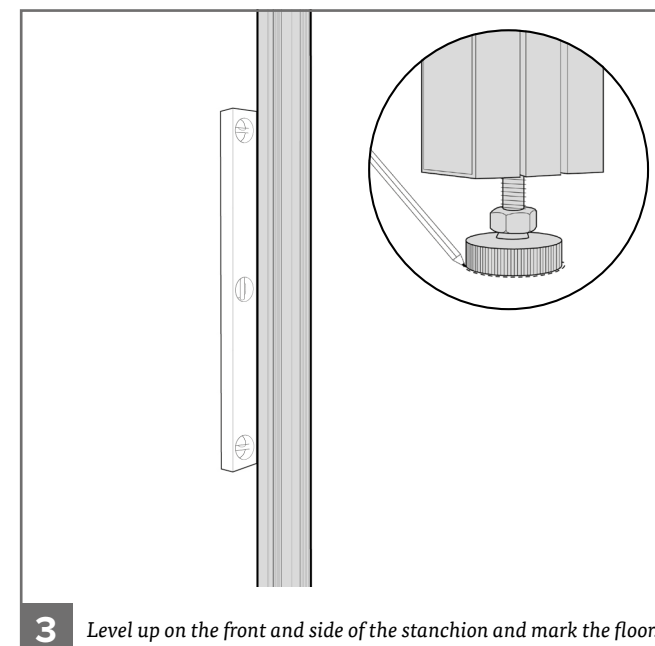
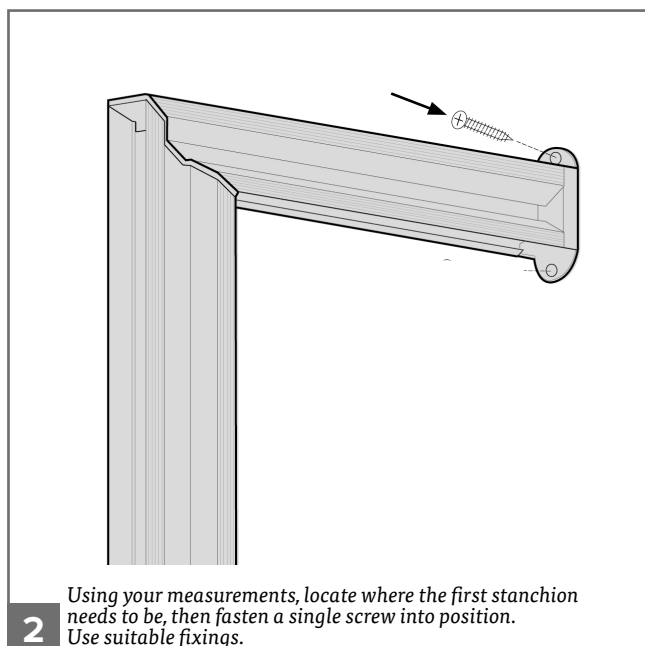
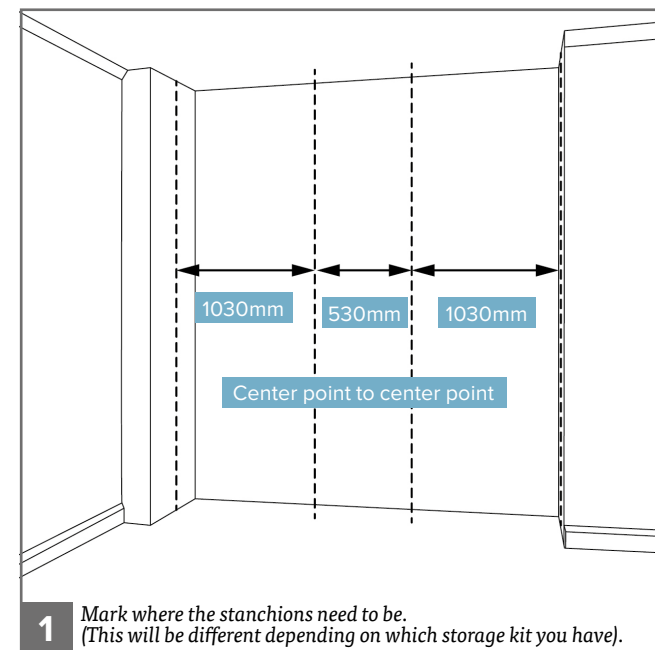

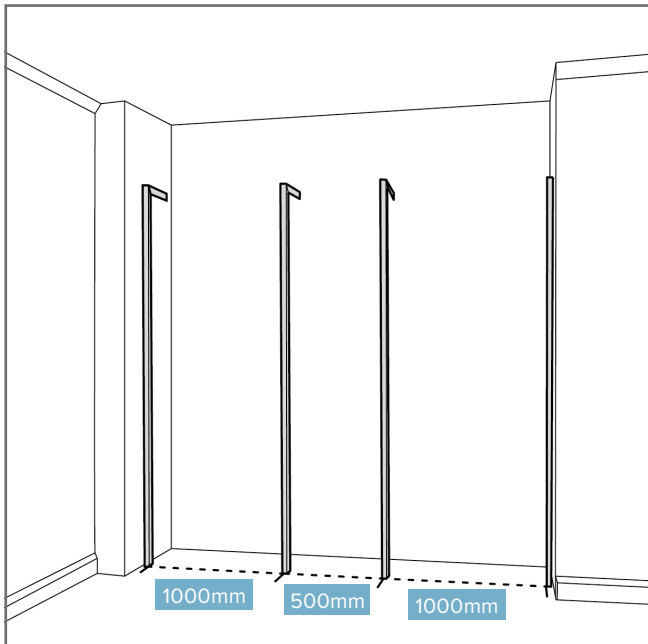
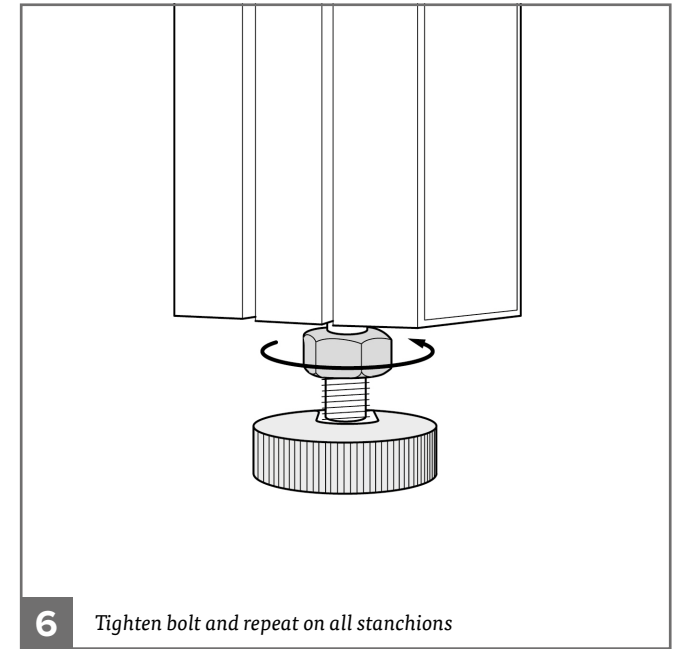
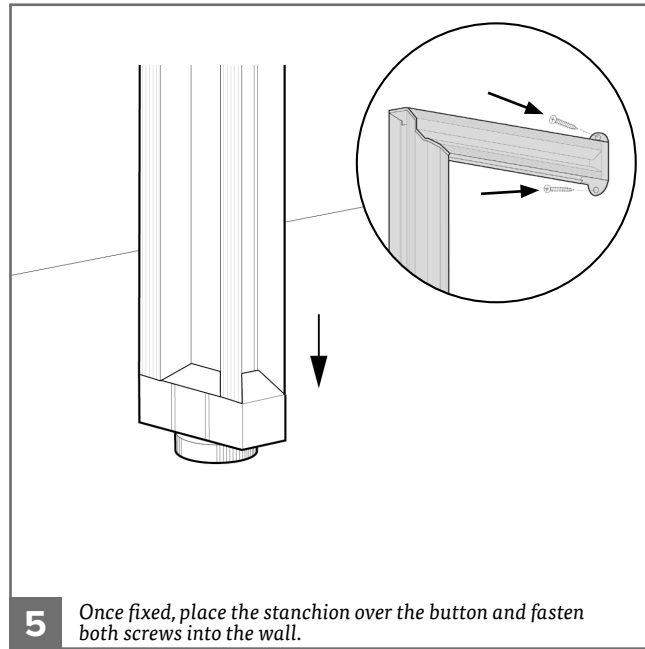
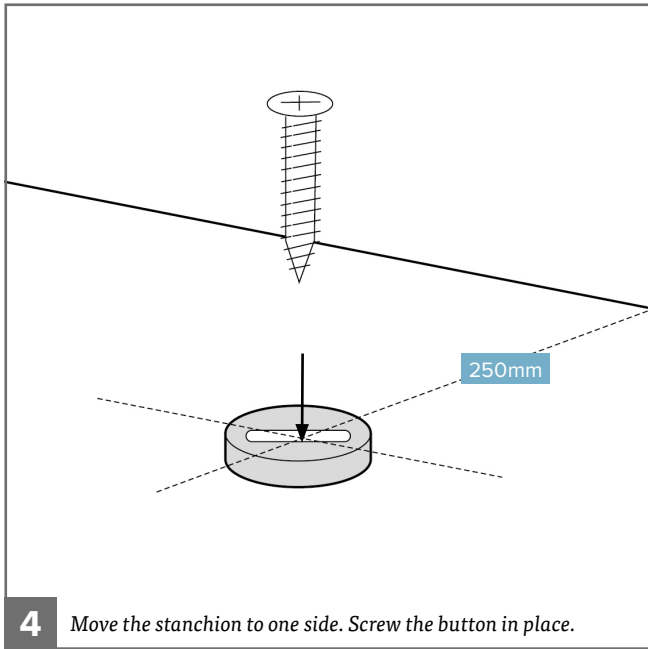

FIXING HANGER BARS

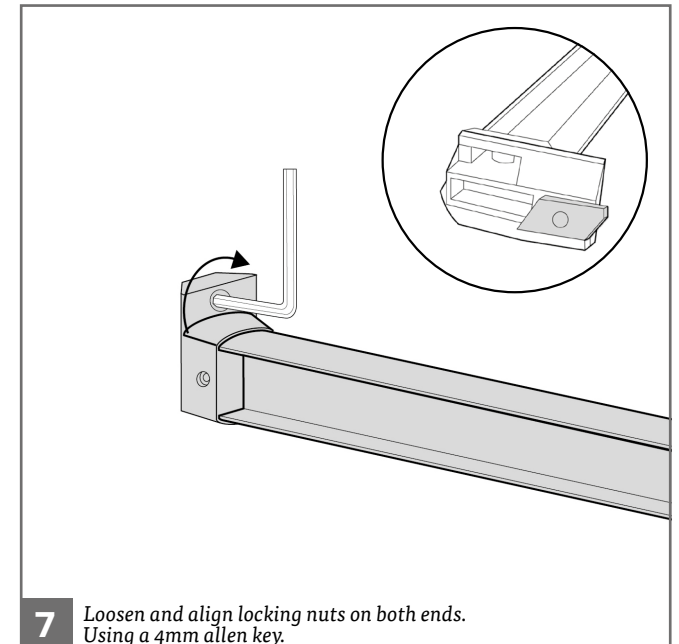

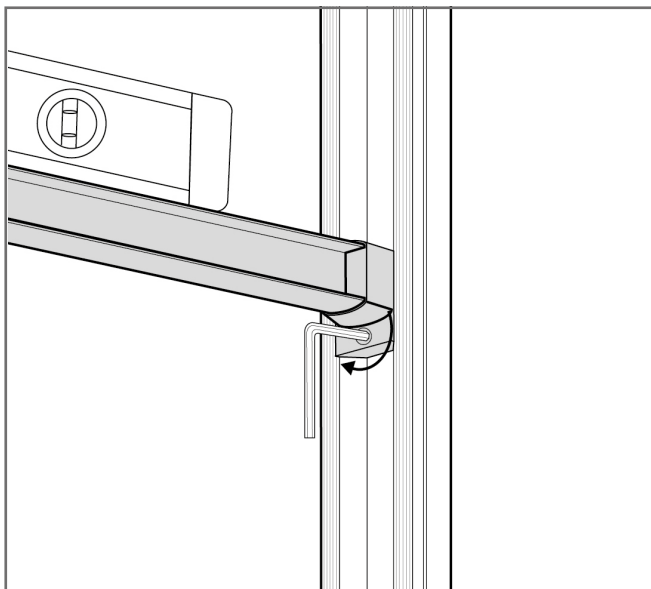

8 Position hanger bar and level up. Tighten the locking nut to fix.

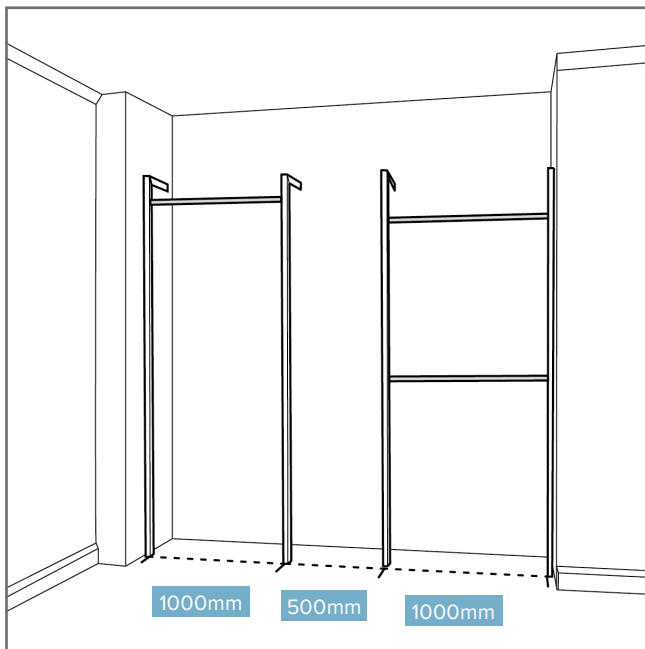

FIXING SHELF BRACKETS

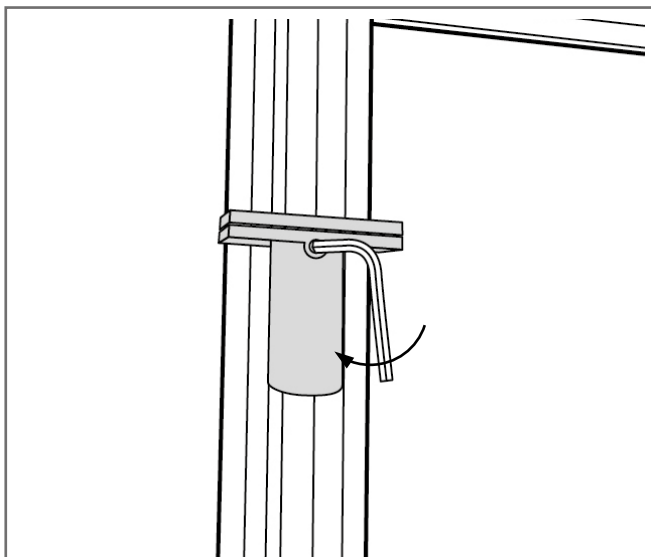

9 Position shelf brackets and level up. Tighten the locking nut to fix.

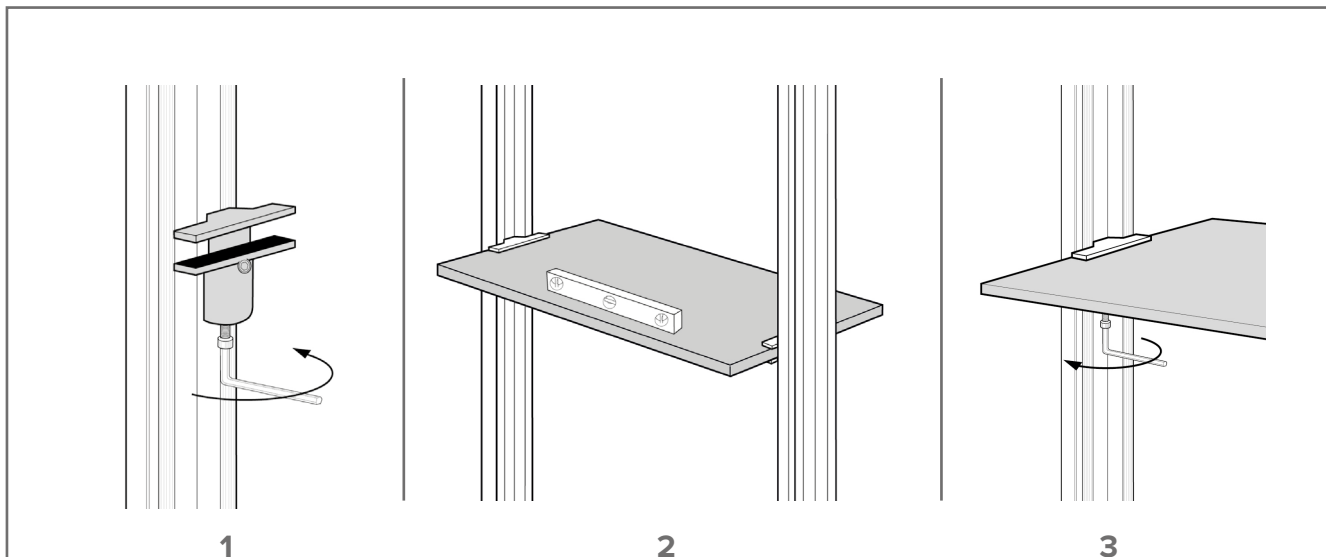

10 1- Open the clamps using the bottom screw (4mm allen key) and slide shelf into place. 2- Level up, ensure you tighten both bolts on each bracket. Repeat this for all shelves.

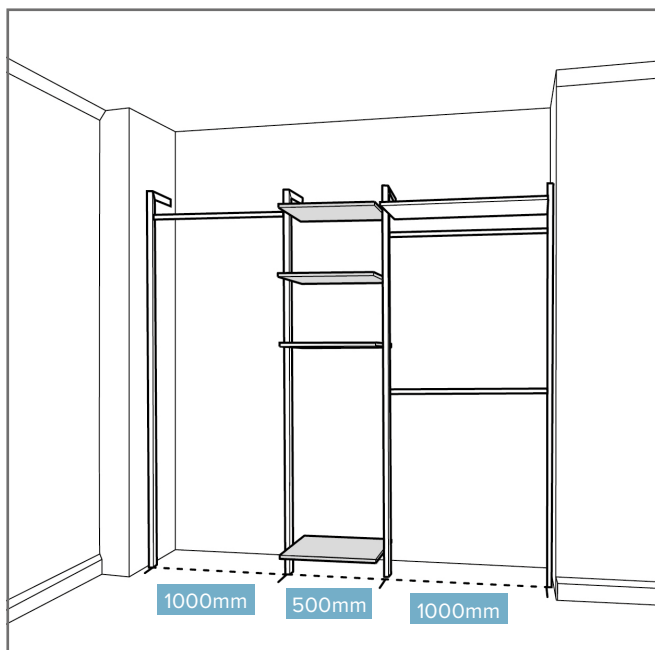

FIXING DRAWER UNITS

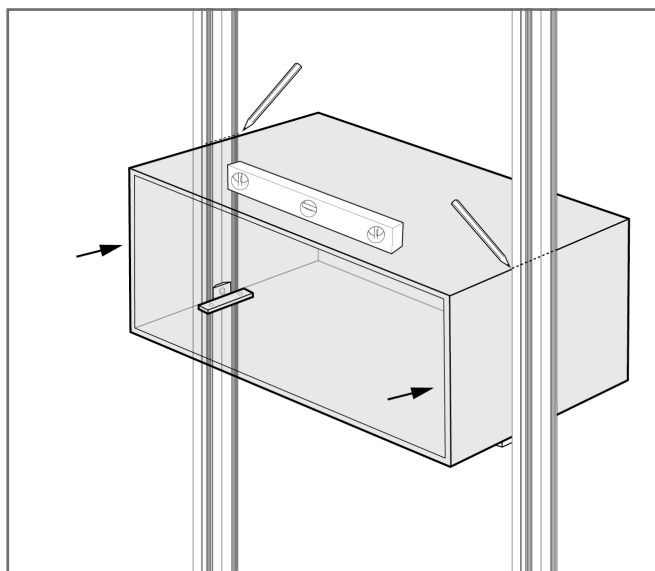
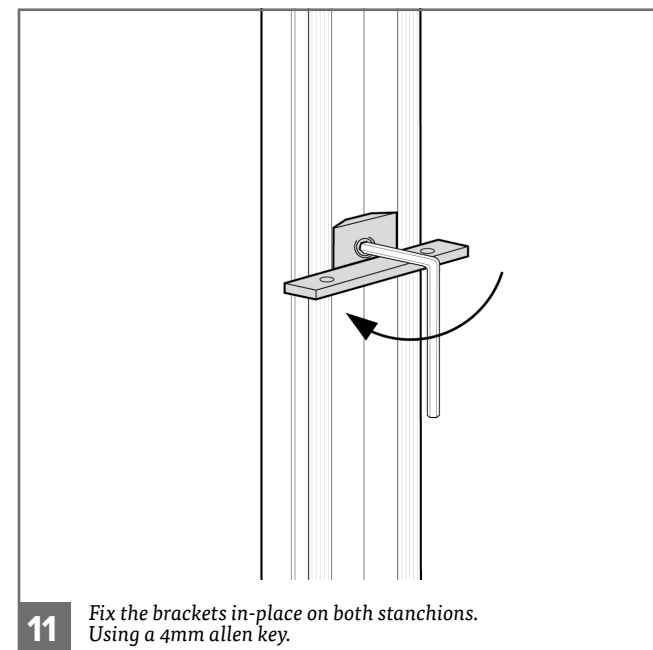

12 Place drawer unit in-place, ensuring you level it up. Then mark at the top, on both stanchions.

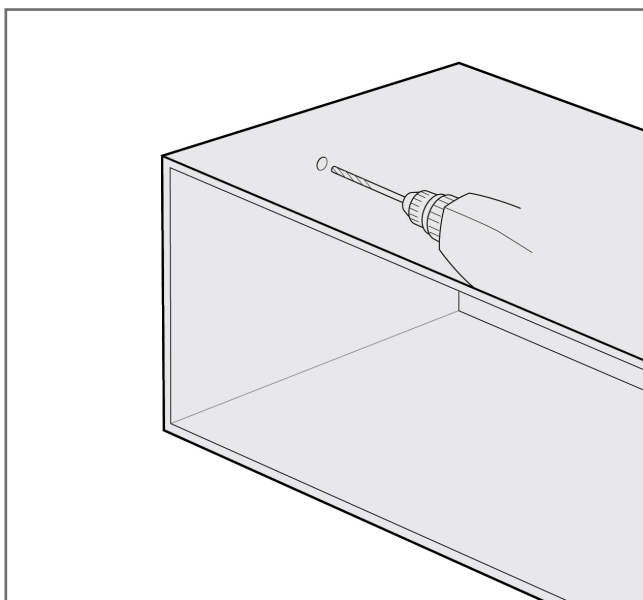

13 Remove drawer unit from stanchions. Drill through the internal pilot holes on both sides.

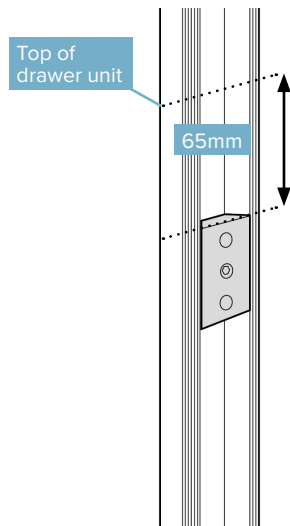
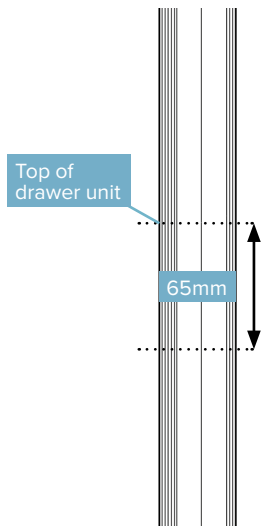

14 Measure 65mm down from pencil mark. Align top bracket to the lower mark on both stanchions and fix in place.

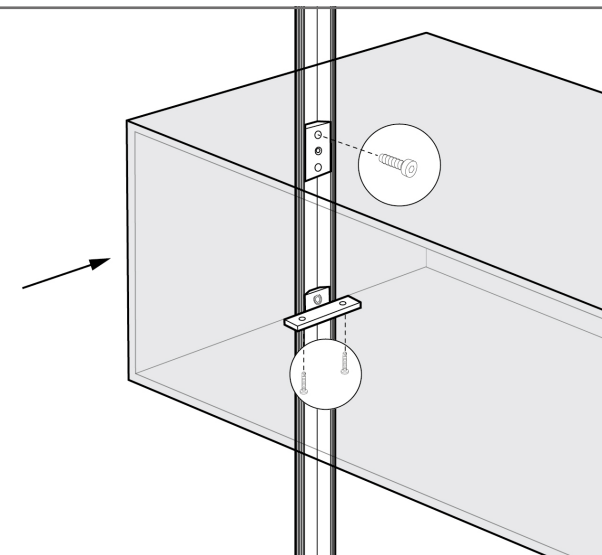

15 Place the draw box back and fasten the bolts into the top bracket on both sides. Fix the drawer box to the bottom brackets using screws (we recommend you drill a pilot hole first).

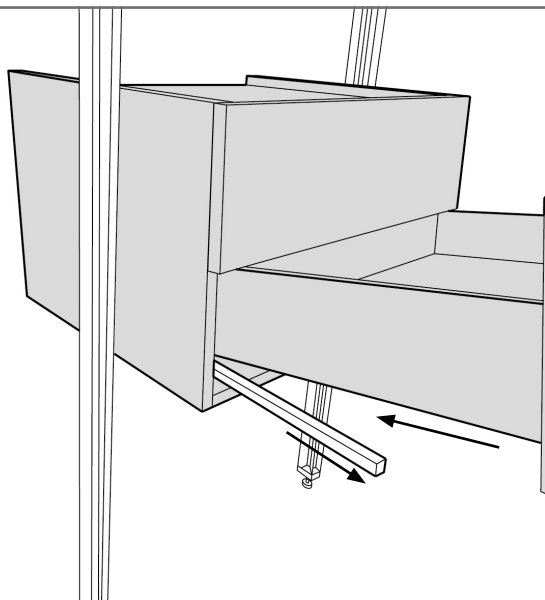

16 Pull out all drawer runners and slide drawers into place.

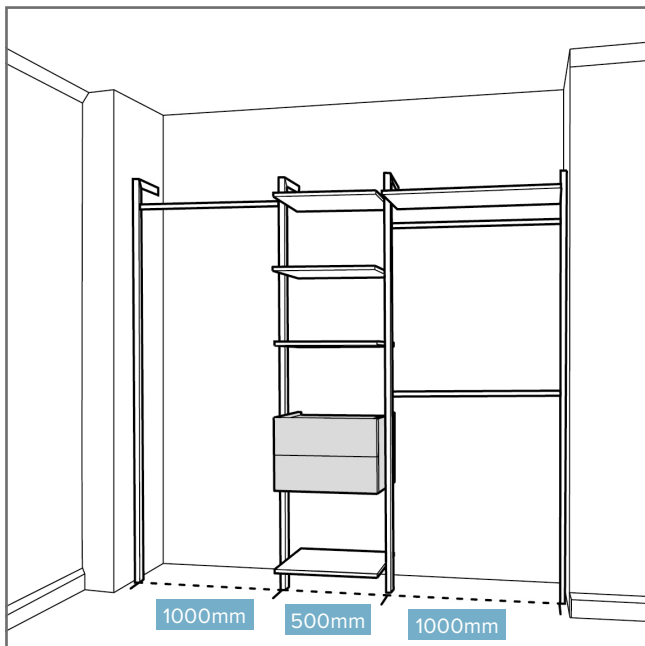

FIXING SHOE RACKS

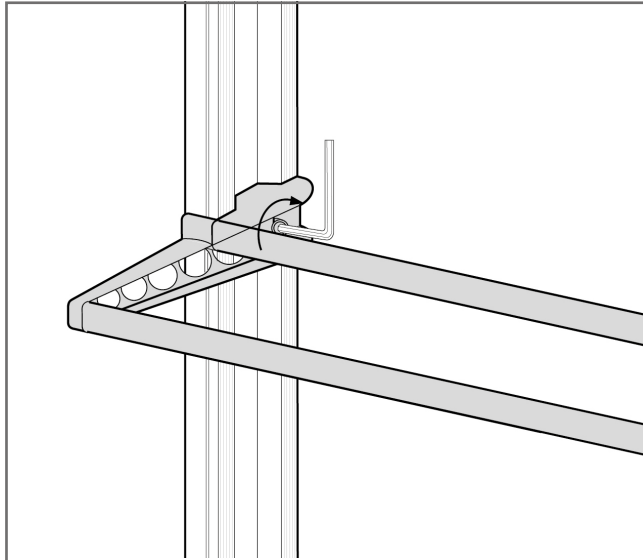

17 Position and fix in-place on both sides. Ensuring you level it up. Tighten up using 4mm allen key.

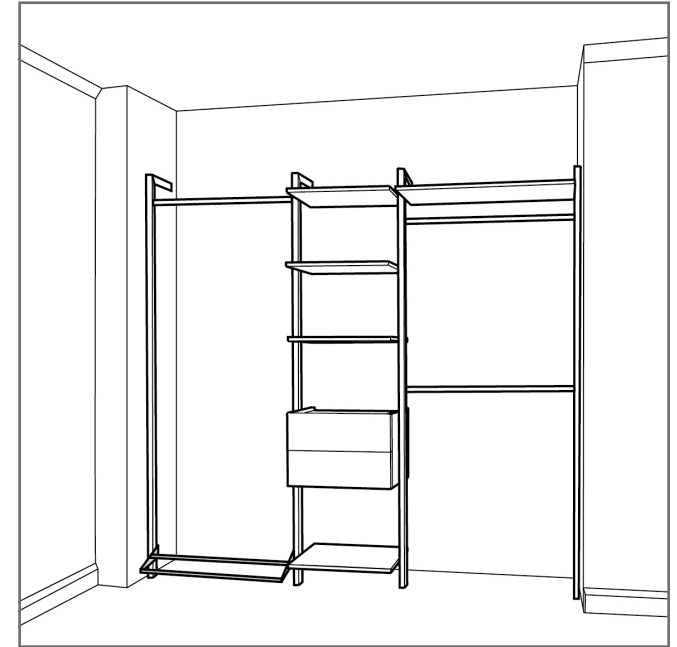

CUTTING/ADJUSTING THE STANCHIONS

If you need to cut down the stanchions for any reason follow the next steps.

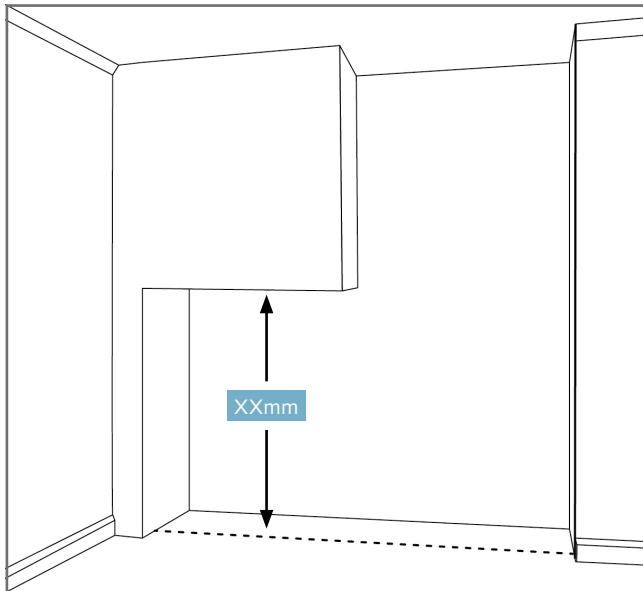

18 Measure the height of your space.

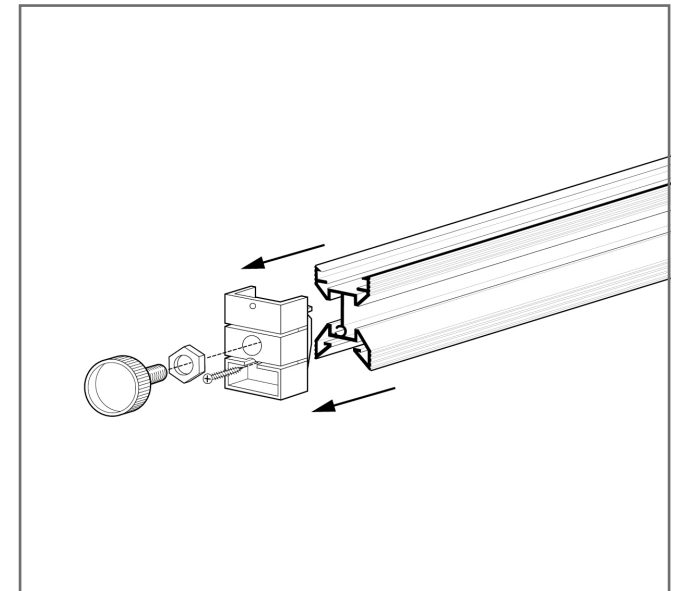

19 Remove adjustable screw and bottom cap from the stanchion.

