

# HOW TO FIT SIGNATURE STORAGE

## Assembly Instruction

### TOOLS REQUIRED:

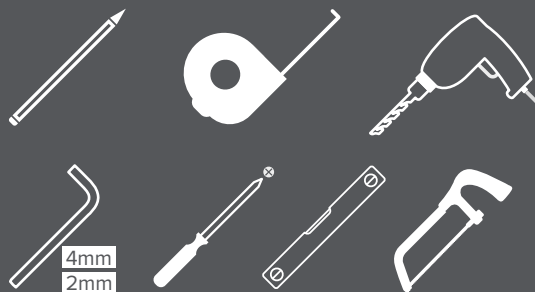

**!** Please check your opening for any hidden electrical wires and water pipes before / screwing.



**⊘** Screws not supplied. Use suitable screws and plugs.

**SIGNATURE**  
BY SPACESLIDE

V1

## MEASURING SPACE FOR THE STANCHIONS

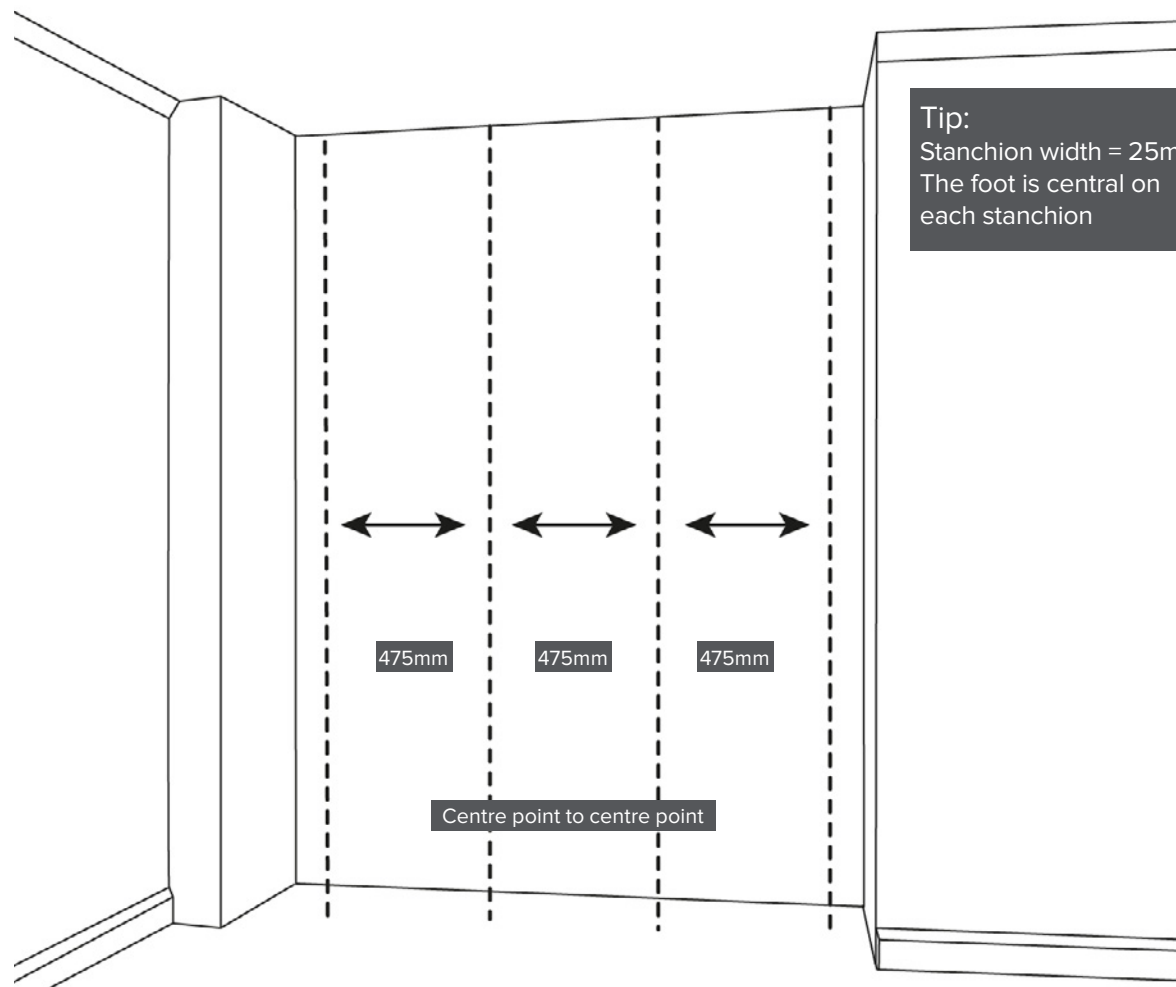

**1** Mark where the stanchions need to be. Add 25mm for each shelf or drawer unit (450mm) to calculate the centre point.

# CUTTING/ADJUSTING THE STANCHIONS

*If you need to cut down the stanchions for any reason follow the next steps.*

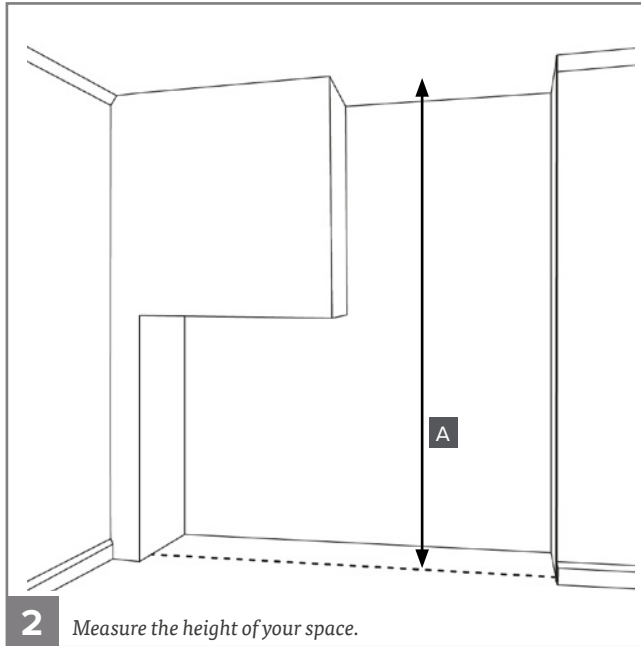

## Floor to ceiling

Opening height "A" - 72mm = Stanchion cut length.

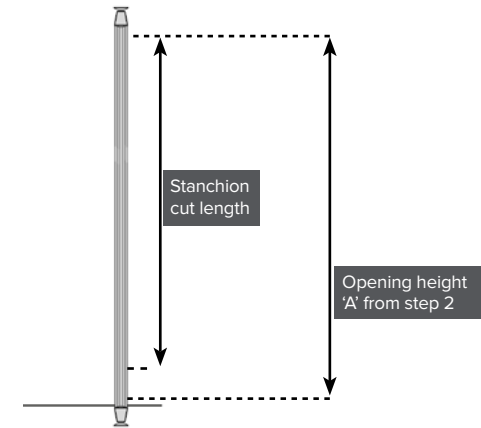

## Floor to Wall

Opening height "A" - 272mm = Stanchion cut length.

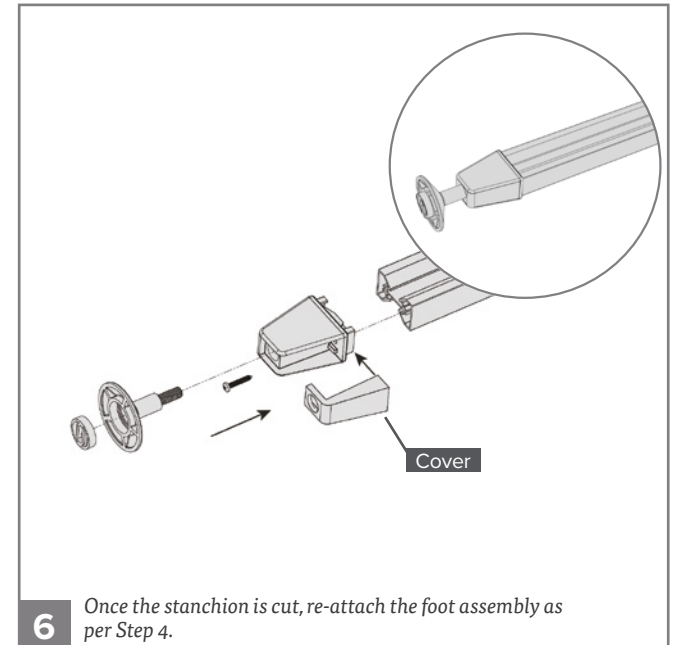
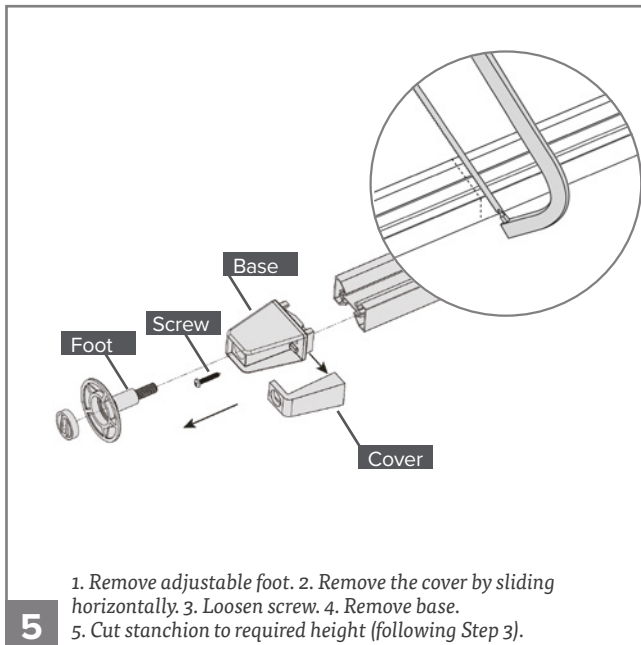
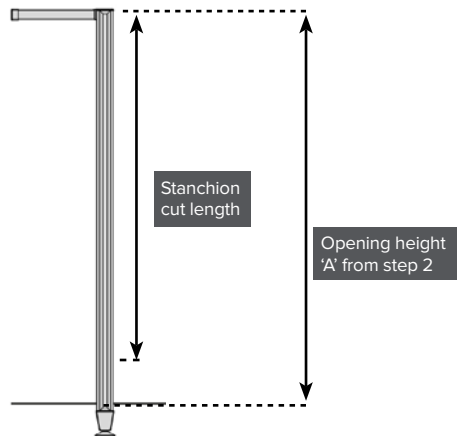

# FLOOR TO WALL STANCHIONS

## Assembly & Fitting guide

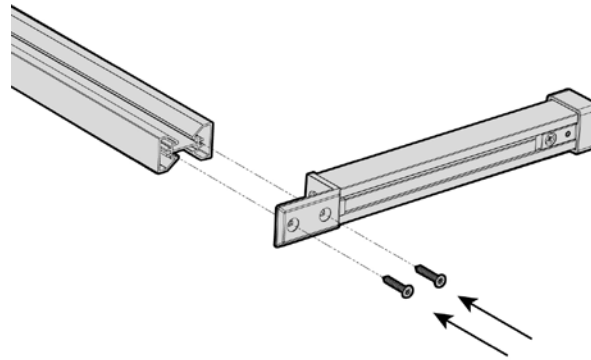

**7** Attach the horizontal profile to the vertical stanchion with the two screws supplied.

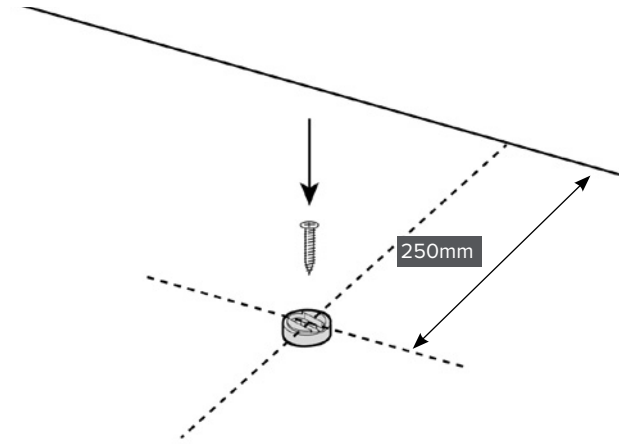

**8** Using your measurements from Step 1, measure 250mm from the wall in a straight line and screw button into place using suitable fixings for your floor.

**Tip:**  
Screw the foot into the body to ensure all stanchions will be at the same height.

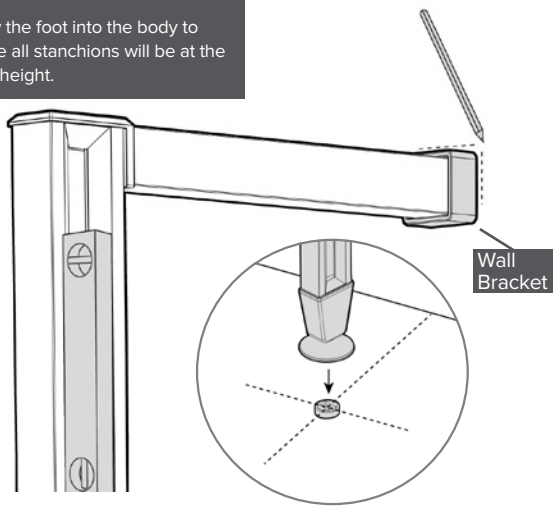

**9** Place the stanchion on the button. Level up from the side of the stanchion and mark the floor.

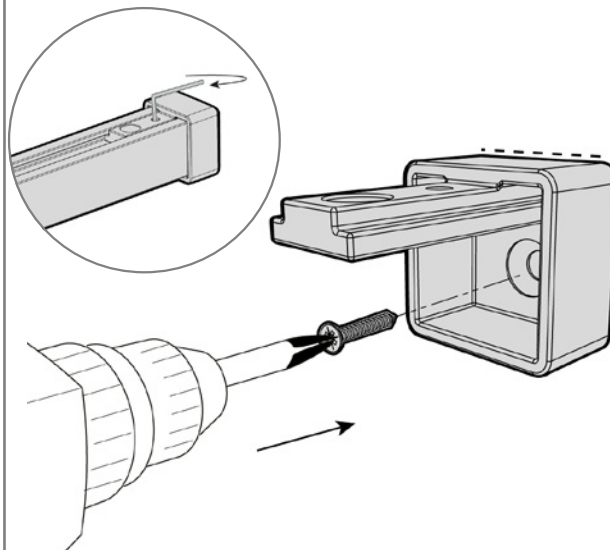

**10** Remove the wall bracket from the stanchion, you will need a 2mm allen key. Position the wall bracket inside the wall markings. Drill and fasten the bracket with suitable fixings.

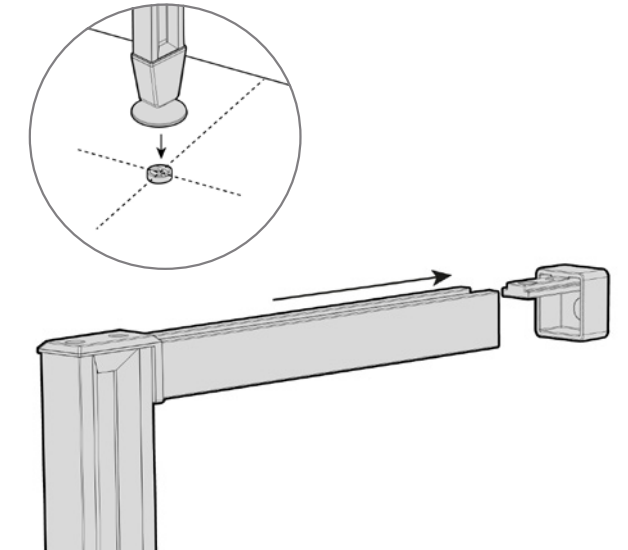

**11** Place the stanchion on to the button as in Step 8. Slot the stanchion back onto the bracket.

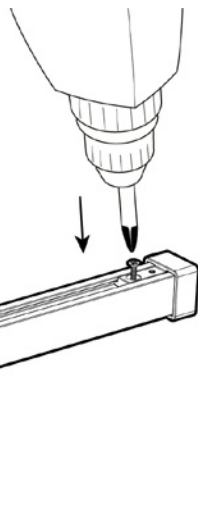
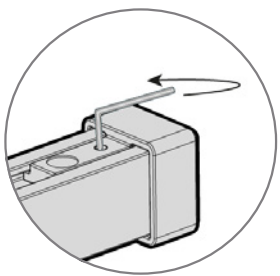

12

Lock the stanchion into the wall bracket with the grub screw. The wall bracket allows for 15mm adjustment. Screw in the supplied screw into the pilot hole to secure the whole installation. Repeat for each floor to wall stanchion.

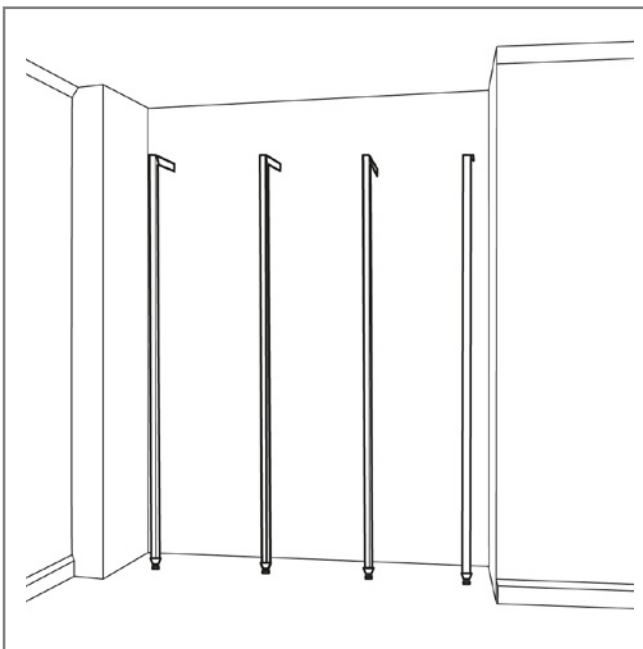

# FLOOR TO CEILING STANCHIONS

## Assembly & Fitting guide

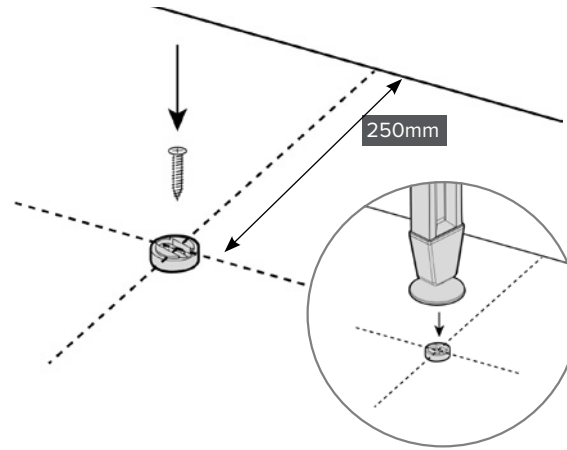

**13** Using your measurements from Step 1, measure 250mm from the wall in a straight line and screw button into place using suitable fixings for your floor. Place the stanchion on the floor bottom over the button

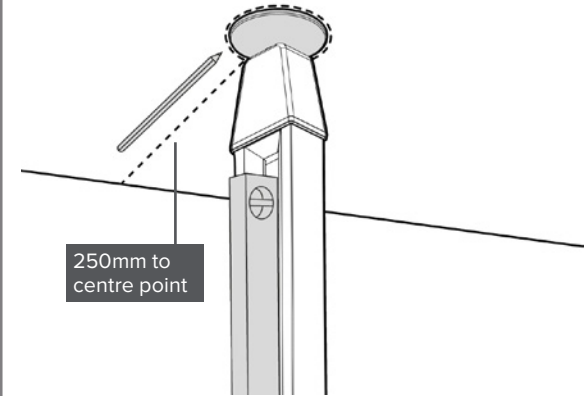

**Tip:**  
Screw the foot into the body to ensure all stanchions will be at the same height.

**14** 1. Place the stanchion over the floor the button  
2. Level up from the side of the stanchion and mark the ceiling.

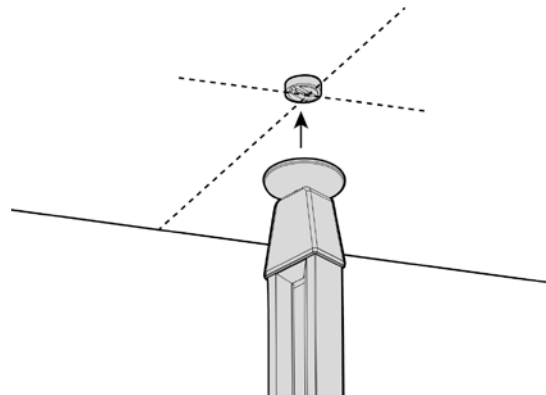
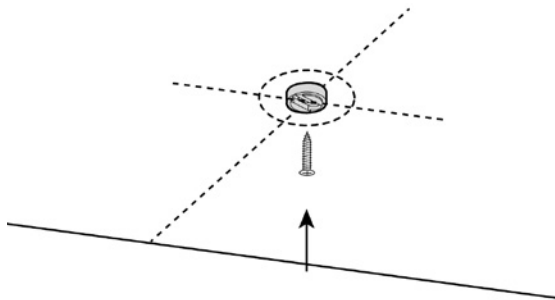

**15** Move the stanchion to one side and using suitable fixings, screw the button to the ceiling.  
Once fixed, place the stanchion over both buttons and fasten into place. Repeat for all floor to ceiling stanchion.

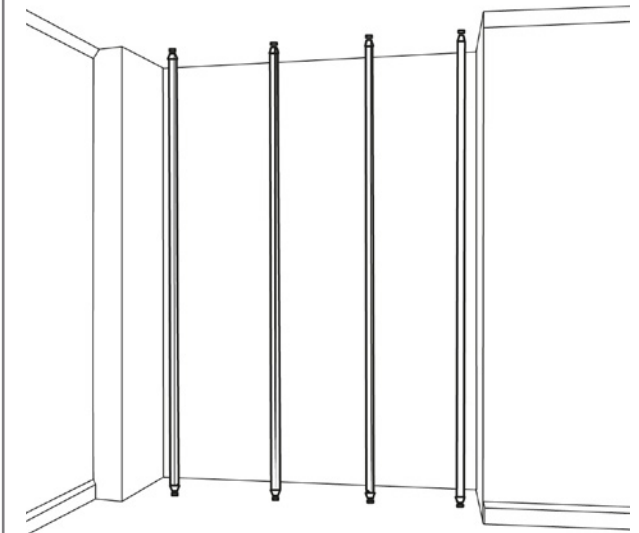

# FIXING HANGER BARS

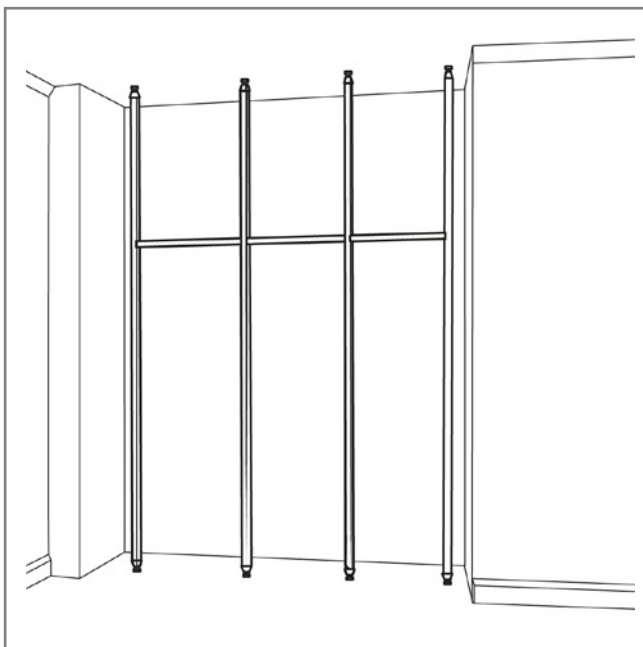
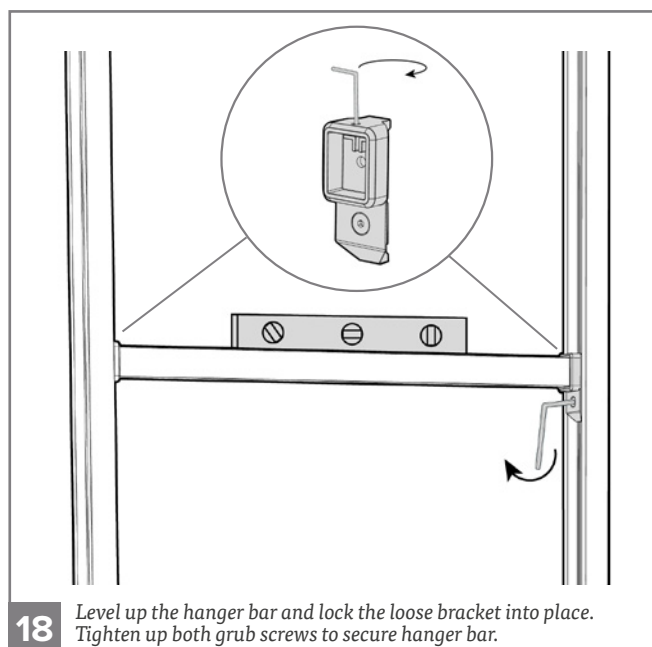
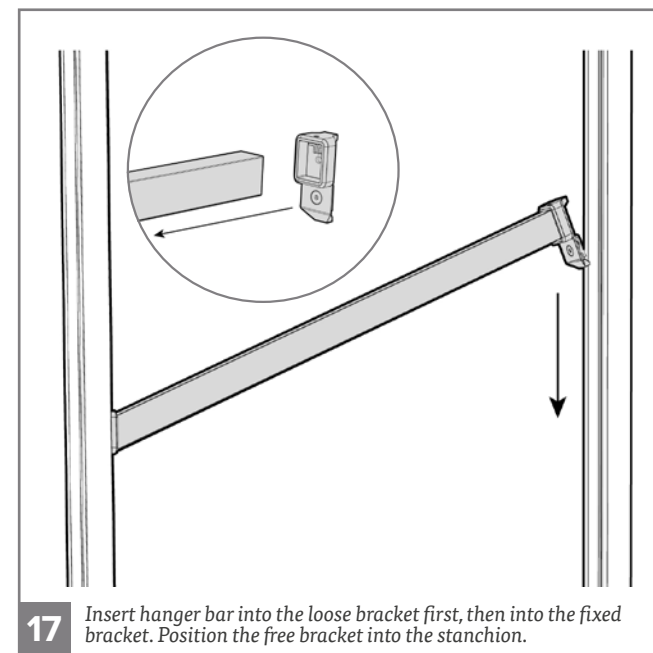
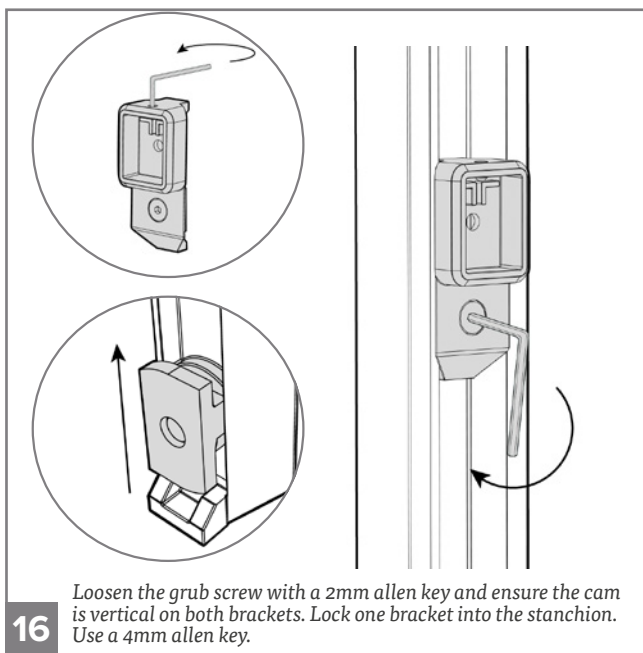

# FIXING SHELF BRACKETS

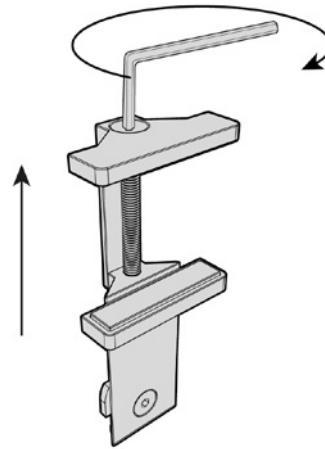

**19** Open both brackets by using a 4mm allen key.

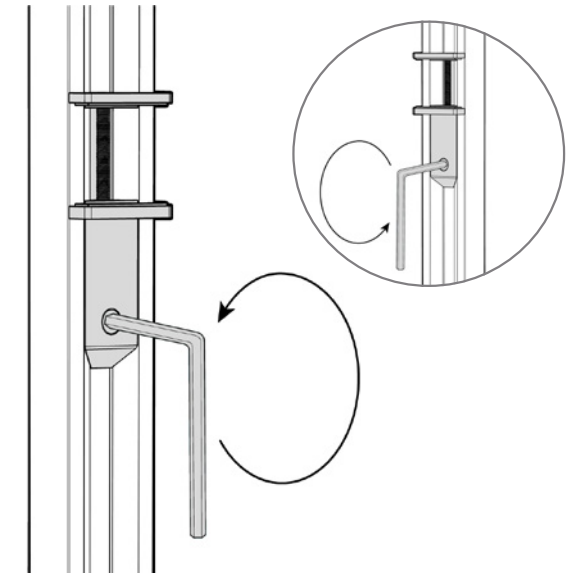

**20** Position and lock both brackets into the stanchion. Use a 4mm allen key.

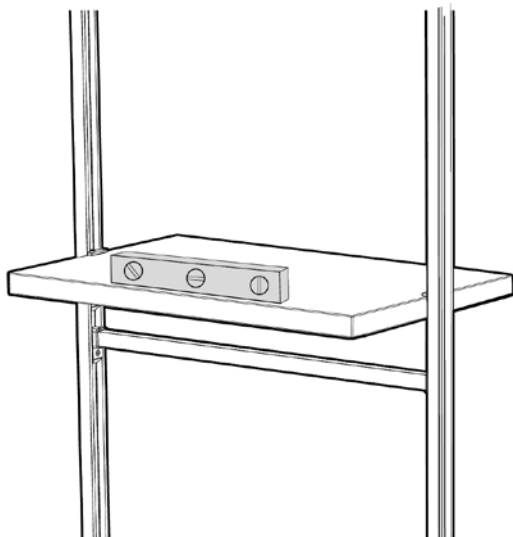

**21** Insert the shelves into the brackets and level up by slightly loosening 1 screw at a time (see Step 18).

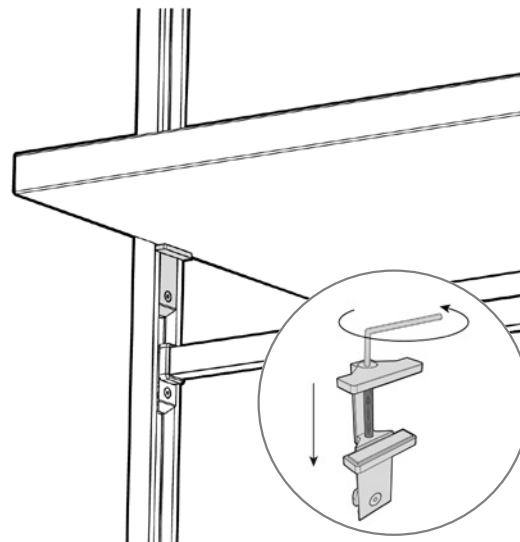

**22** Secure the shelf into place by tightening the top bolt of the bracket.

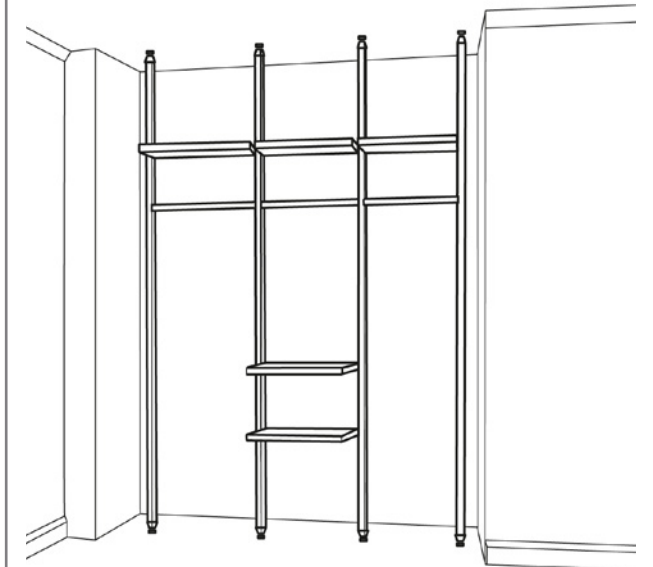

# FIXING DRAWER UNITS

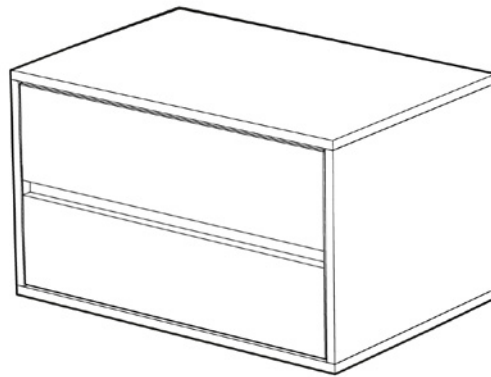

**23** To install the drawer box you will need to remove the drawers.

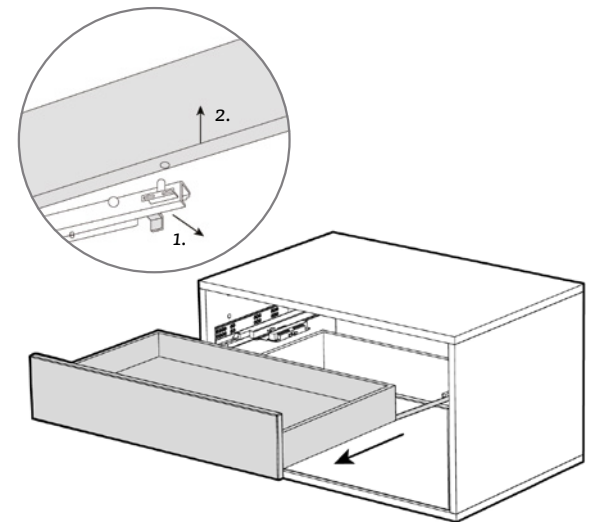

**24** Pull the drawer out to expose the runner. 1. Unclip from the runner and slide towards the centre of the drawer. 2. Lift the drawer free. Repeat for each drawer.

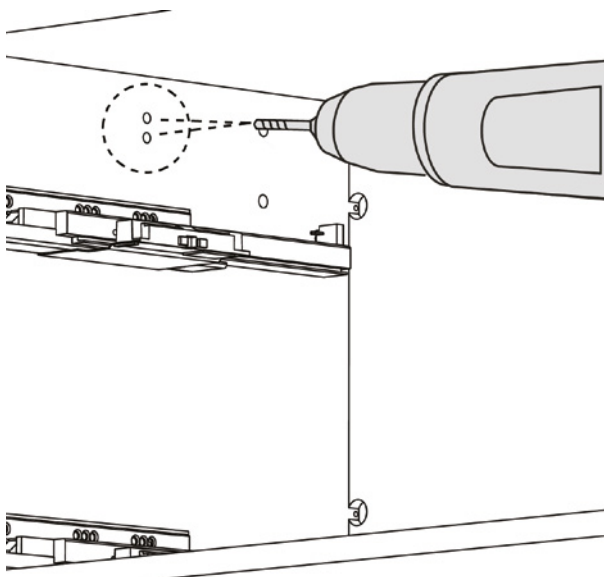

**25** Drill 8mm holes through the two middle pilot holes on both sides.

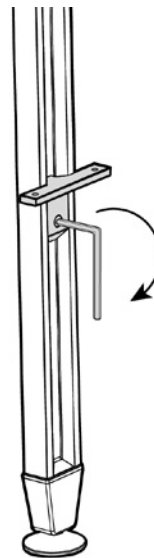

**26** Position and lock brackets into the stanchions. Repeat for all sides.

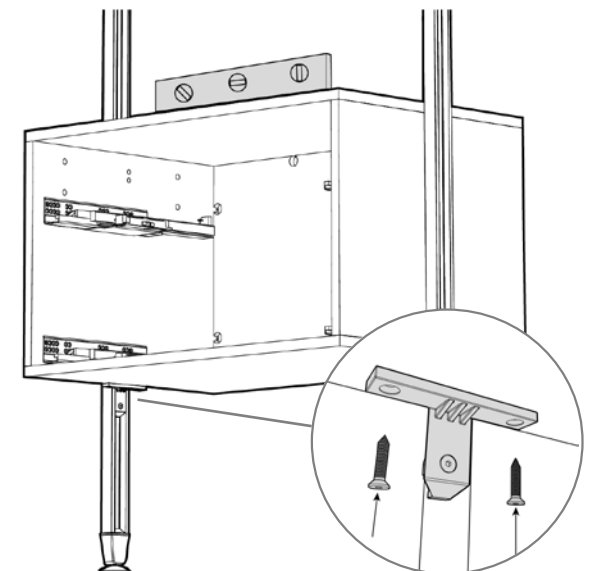

**27** Position the drawer box onto the brackets and level up. Secure the drawer box from underneath with the screws provided.



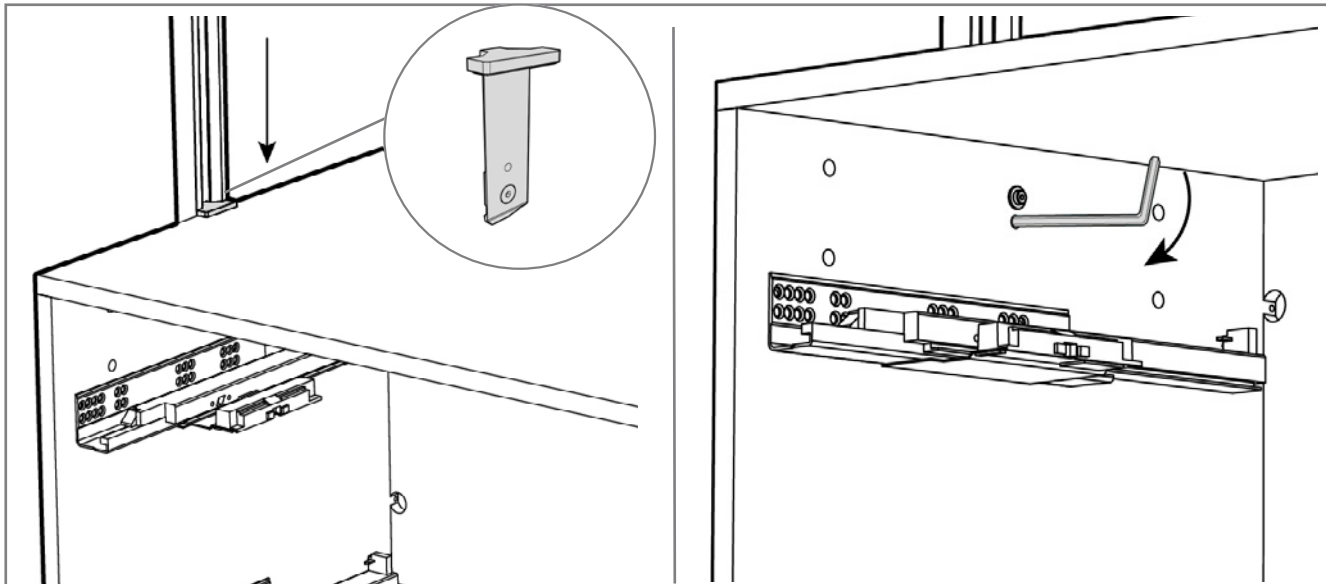

**28** Position the top bracket into place in the stanchion. Lock the bracket into the stanchion through the lower pilot hole. Secure the drawer box into place with a bolt supplied through the top hole into the stanchion and tighten.

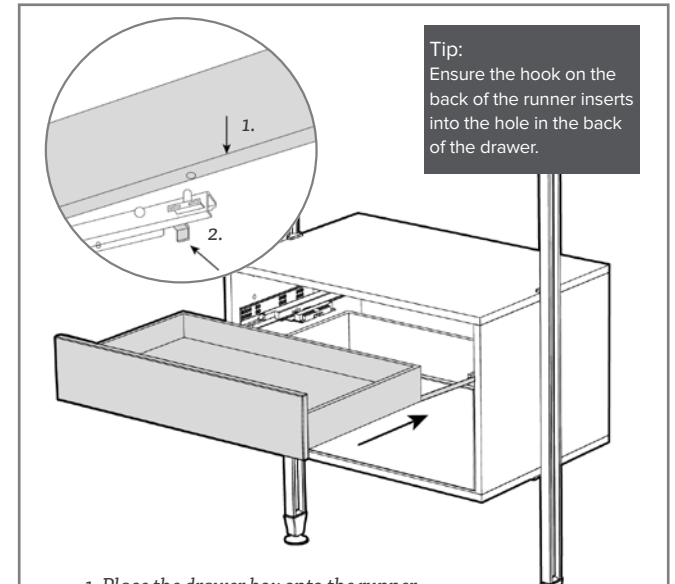

**29** 1. Place the drawer box onto the runner.  
2. Push the clip to secure the drawer box onto the runner.  
Repeat on all draws.

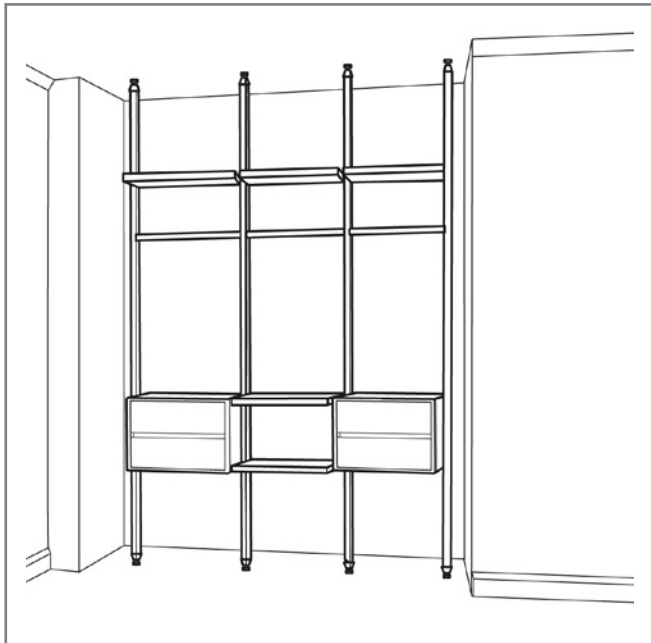

# FIXING SHOE RACKS

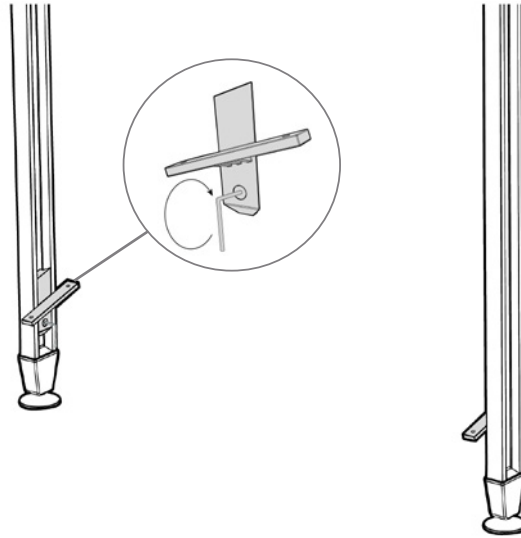

**30** Position both brackets into the stanchions and lock into position. There is a left & right for each bracket.

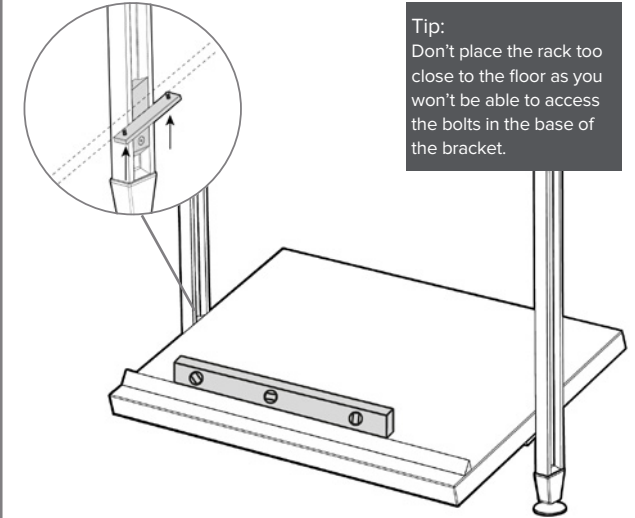

**Tip:**  
Don't place the rack too close to the floor as you won't be able to access the bolts in the base of the bracket.

**31** Position the shoe rack onto the brackets and level up. Once level secure the shoe rack into position by using the screws supplied. You will require a 4mm allen key.

