

BEDSIDE UNIT

Assembly Instructions

CONTENTS:

A 1x Top panel

B 1x Top back panel

C 1x Shelf

D 1x Side panel (left)

E 1x Side panel (right)

F 1x Lower back panel

G 1x Drawer infill

H 1x Base

I 2x Soft close drawer runners
(1x left, 1x right)

J 1x Drawer back

K 1x Drawer side (left)

L 1x Drawer side (right)

M 1x Drawer front

N 2x Soft close clips
(1x left, 1x right)

O 1x Drawer base

P 4x Legs

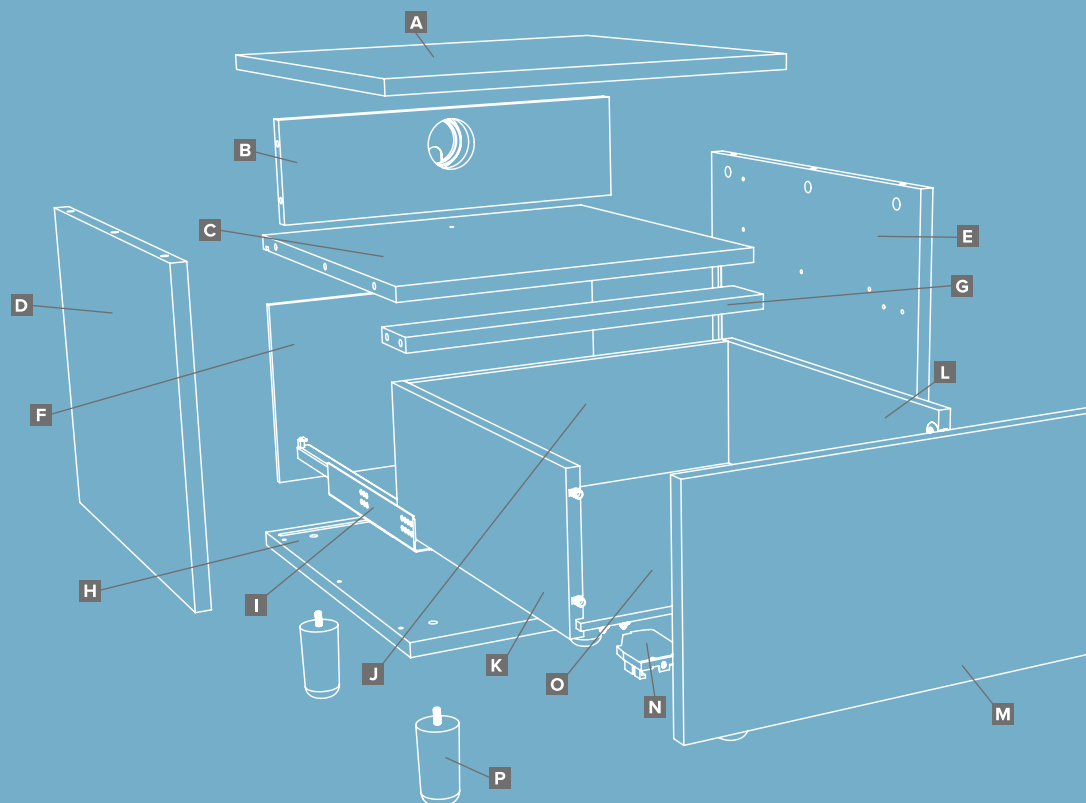
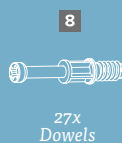

RECOMMENDED TOOLS: Screwdriver & Hammer

spaceslide
we make room

V2

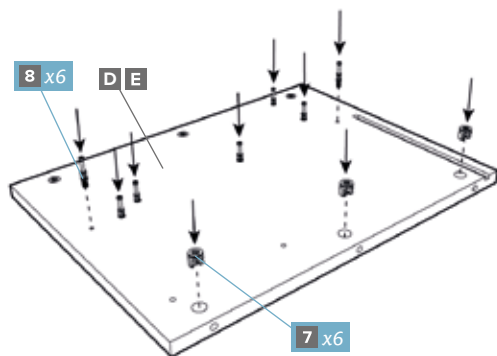

1 Apply to both panels.

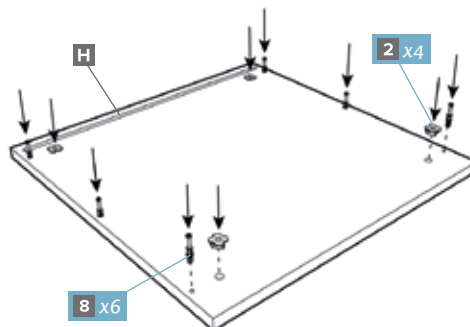

2 Use hammer to tap T-nuts (2) into place.

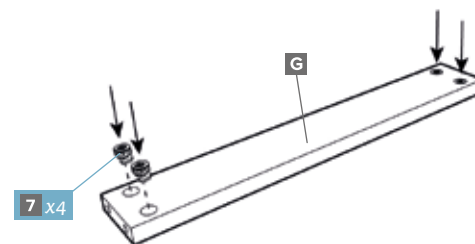

3

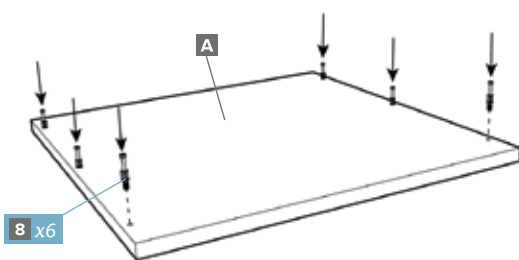

4 (Shown from underneath).

(Shown from bottom).

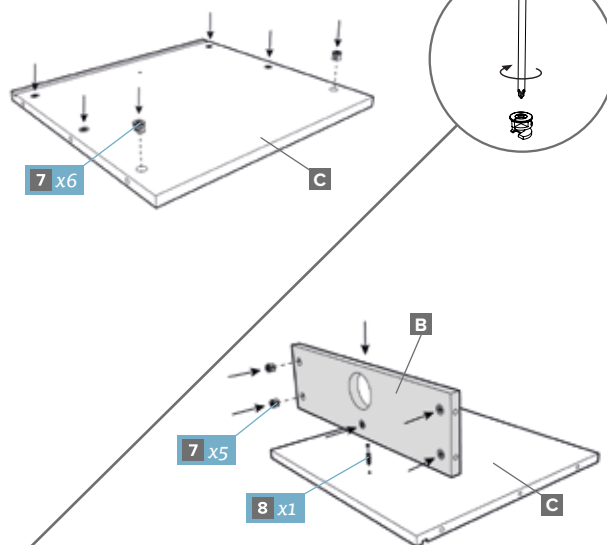

5 (Shown from top).

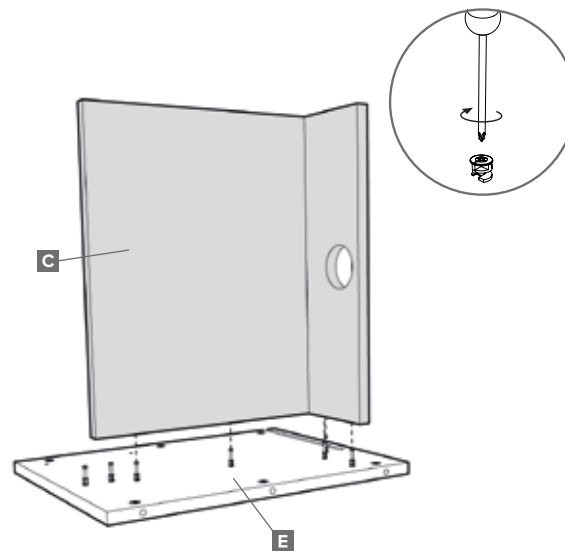

6 Lay panel (E) on a flat surface.

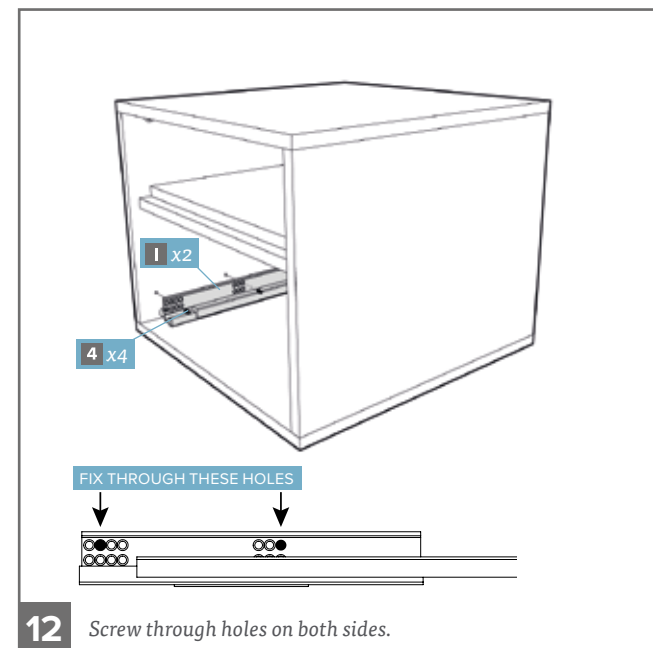
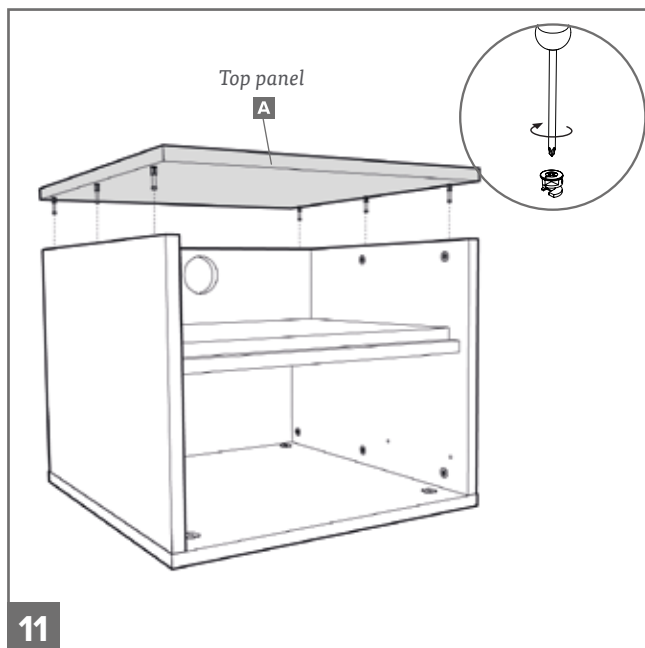
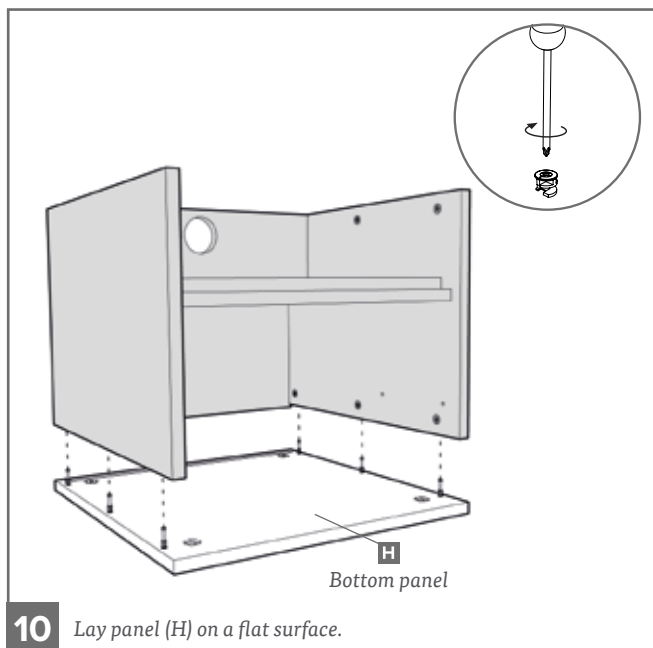
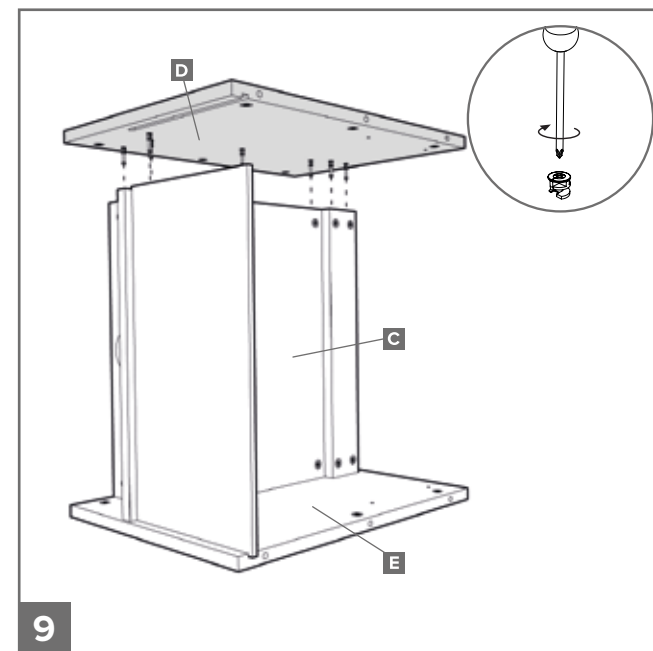
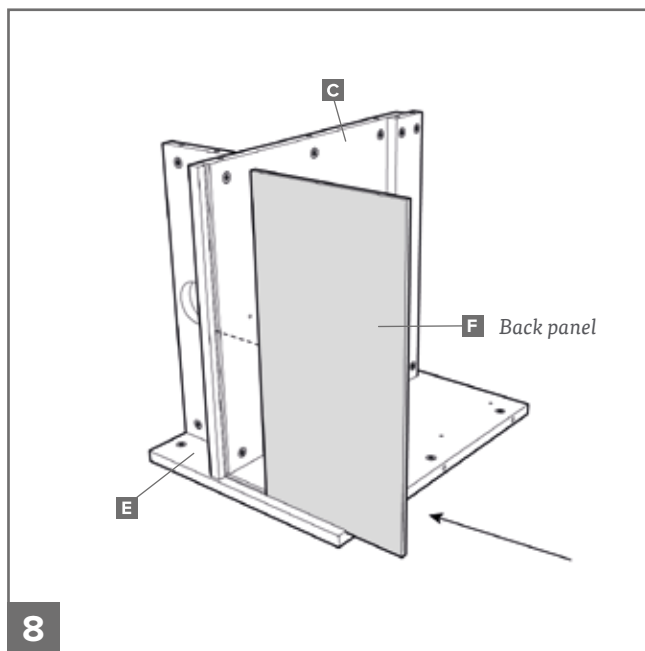
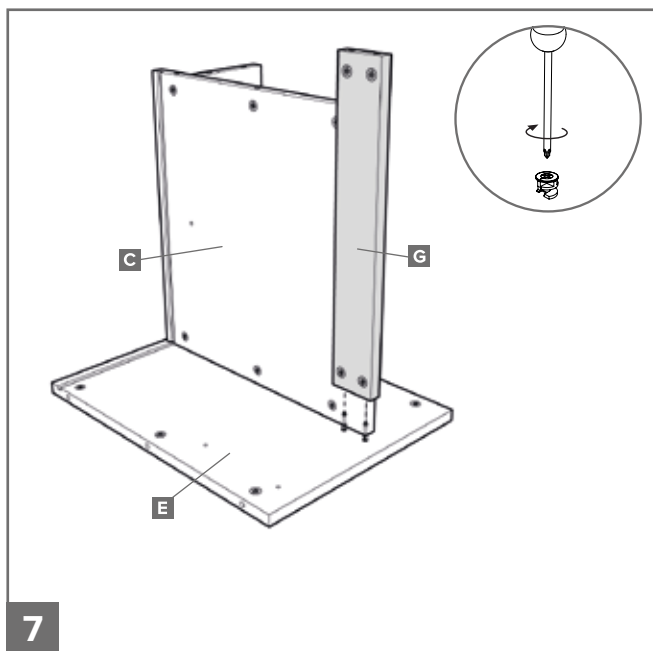

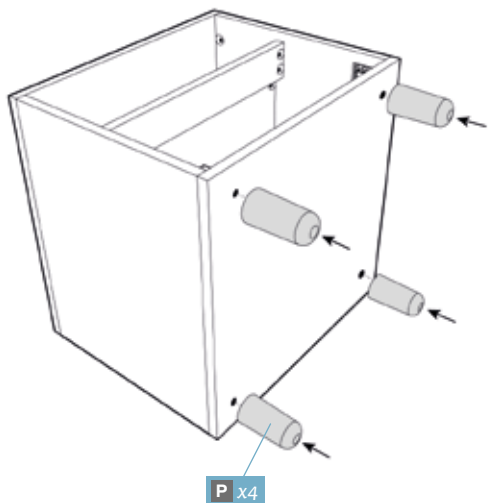

13 Lay the product on its back and then insert legs into the holes and turn until tight.

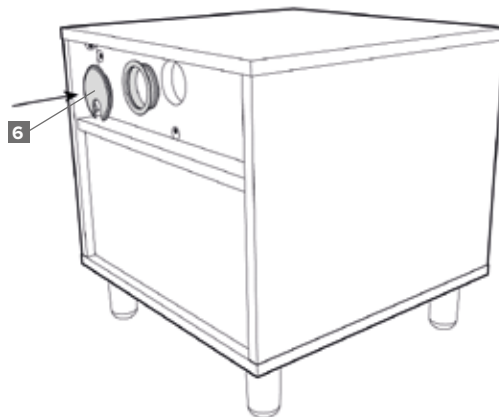

14 Insert the ring from the cable hole plug (6) first, then apply the cover.

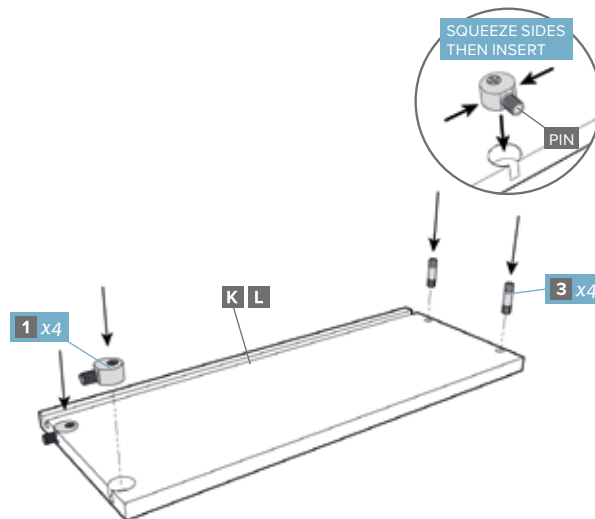

15 Tap plastic dowels gently into place with a hammer (Repeat on all drawer sides).

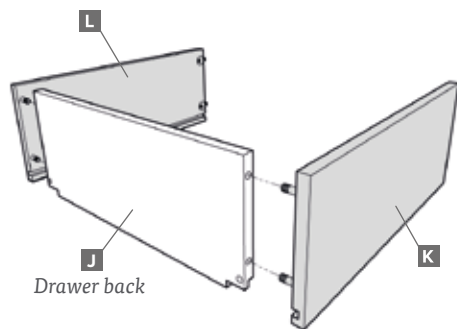

16 Push/tap sides (L&K) onto back panel (J).

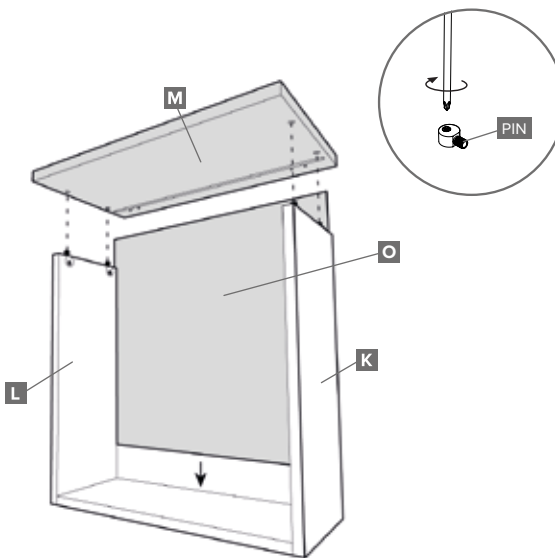

17

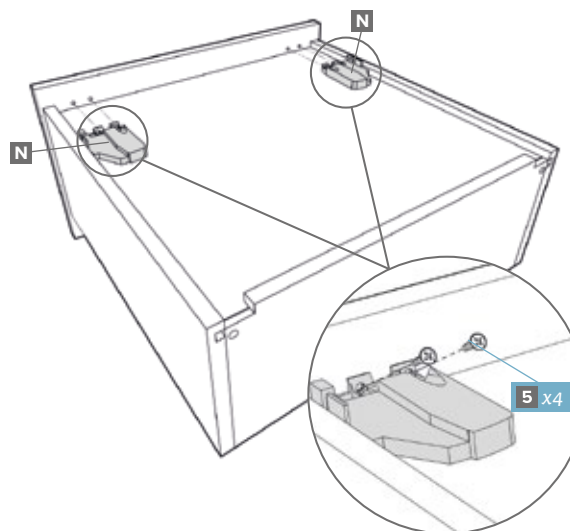

18 Repeat on all drawers. (Drawer shown from underneath).

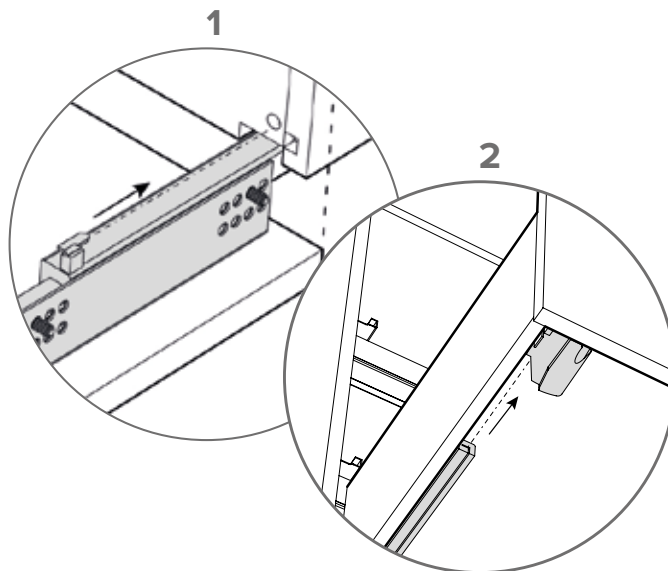
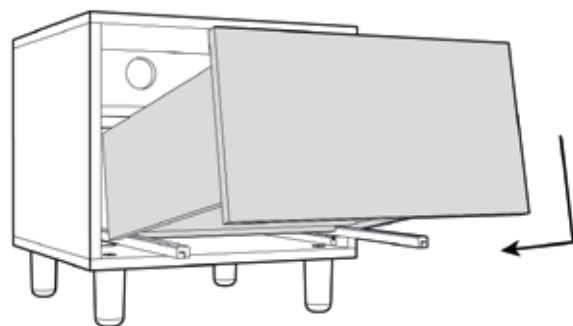

19

- 1 – Slide the drawers so that the prong goes into the hole in the back of the drawer.
- 2 – Pull the sliders forward, until you hear a click, repeat on both sides.

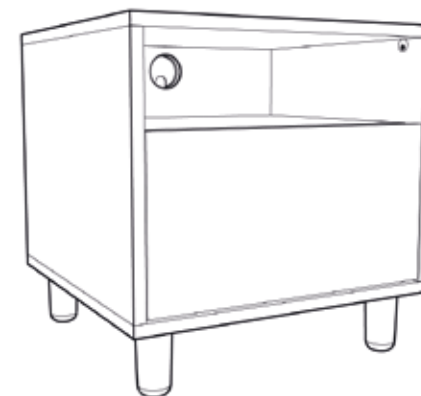

BEDSIDE UNIT POWER CUBE

Assembly Instructions

spaceslide®
we make room

V1

