

Installation Instructions

SPACESLIDE ROOM DIVIDER SYSTEM

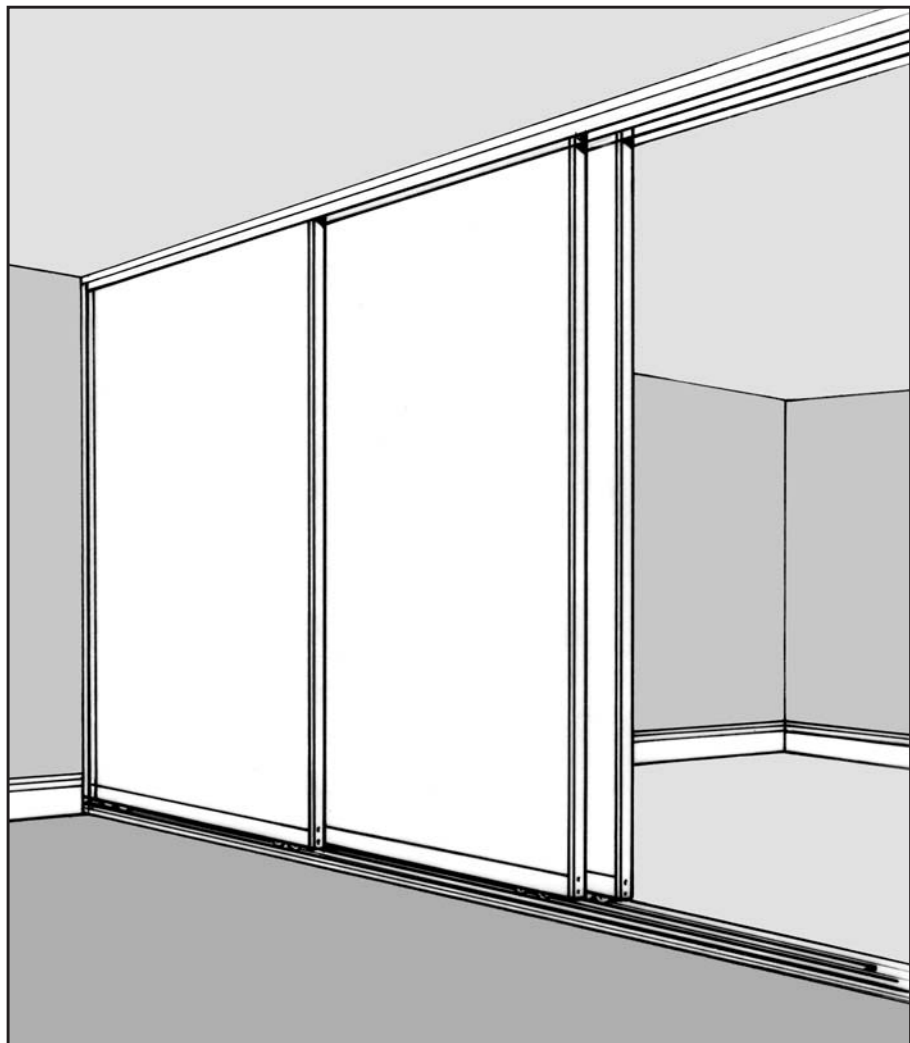

IMPORTANT: Ensure there are no water pipes or electrical cables in the area of the installation.

The system is supplied complete with outer frame consisting of twin or single top track, twin or single bottom track and twin or single wall uprights together with door leaves.

The outer frame profiles are supplied approximately 100mm oversize for cutting down on site to allow accurate installation to aperture on sites. Adjustment of +/- 5mm on designed size can be made to the outer frame.

The installation sequence for the outer frame is bottom track cut to order size. Top track is fitted between the outer stiles therefore the cutting size is bottom track size minus 38mm. The outer stiles are installed on top of the bottom track and run full height - cutting size is order size minus 8mm.

TWIN DIVIDER SYSTEM

Top Track

83mm wide

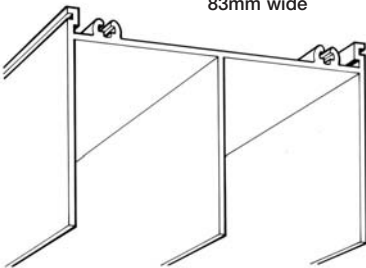

Bottom Track

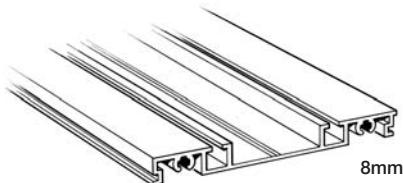

83mm wide

SINGLE DIVIDER SYSTEM

Top Track

45mm wide

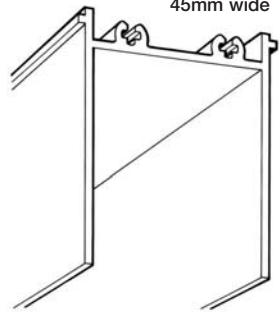

Bottom Track

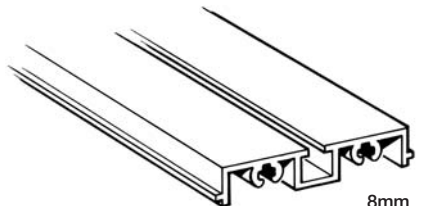

45mm wide

SINGLE TRACK SYSTEM

Used when a single door is required to seal on opening or bi-parting doors on the same track.

MULTI TRACK SYSTEM

The single track system can interlock with twin track to give a three track or four track system to allow stacking doors to the end.

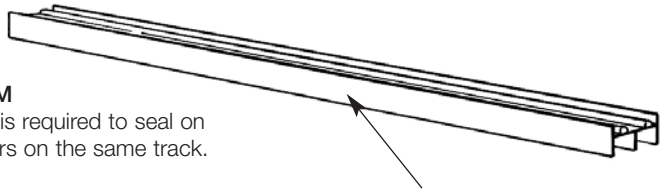

Top Track

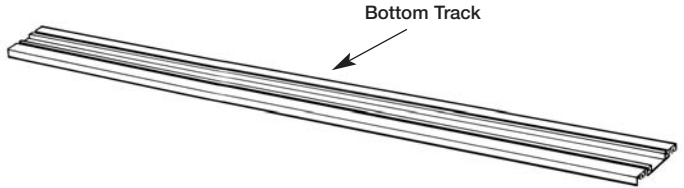

Bottom Track

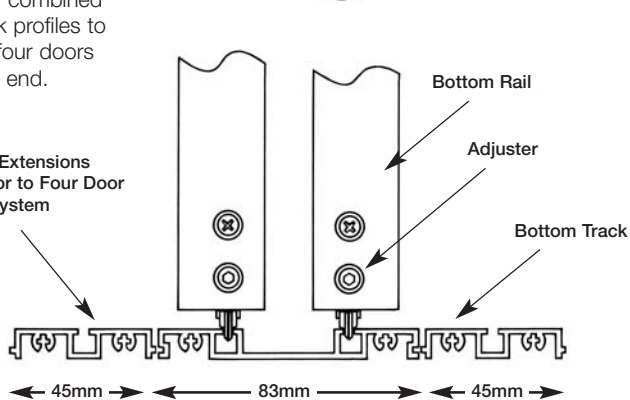
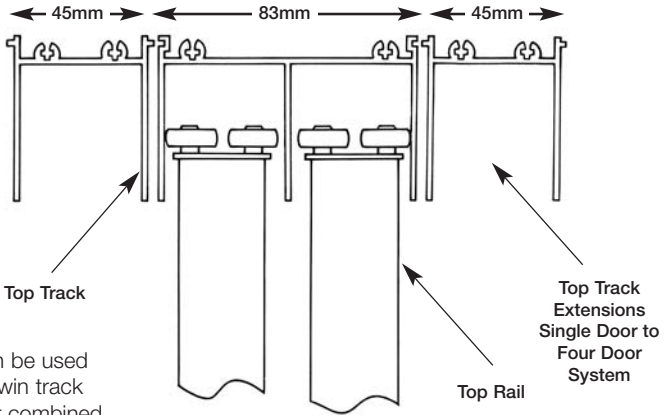

The system can be used as a standard twin track configuration or combined with single track profiles to allow for up to four doors stacking to one end.

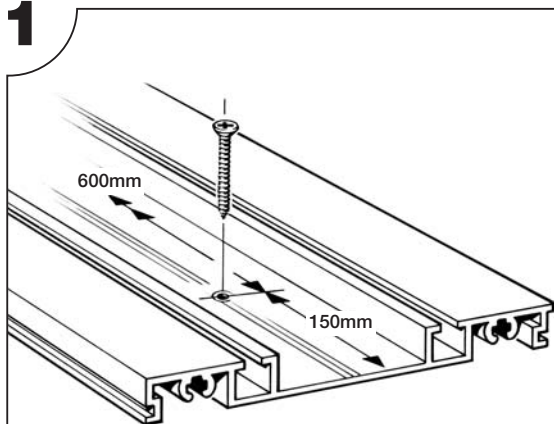
1

INSTALLING THE BOTTOM TRACK

Bottom track will need to be cut to the correct size. Mark the profiles with a set square and cut using a hacksaw as accurately as possible. Drill 5mm clearance holes in the centre of the profile, 150mm from each end and at 600mm centres.

Place track in position, use a spirit level to ensure flat and secure to structure - do not overtighten as this may deform the track.

2

UPRIGHTS

Place outer upright in position. If fixing to brickwork mark the position of the fixing holes central on the wall and drill 5mm clearance holes in centre of the profile cavity, 150mm from each end and at 600mm centres.

Using a spirit level ensure the profile is plumb in both directions and secure to structure.

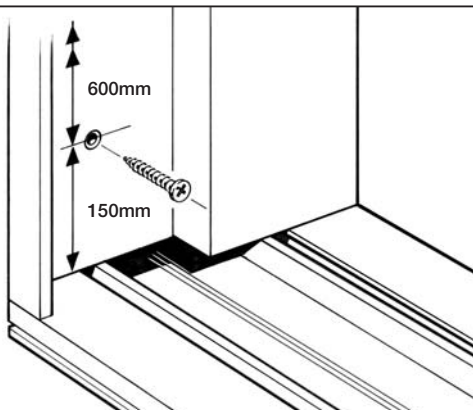
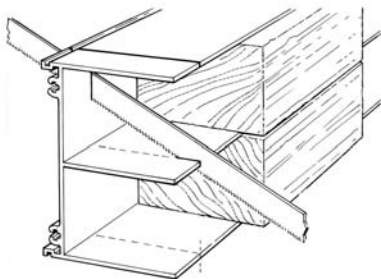
**3**

INSTALLING TOP TRACK

Top track will need to be cut to fit between uprights. To assist when cutting insert timber blocks into top track for support, as illustrated.

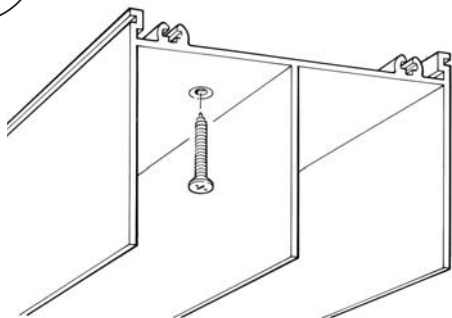
4**INSTALLING TOP TRACK**

Drill 5mm clearance holes in either channel. Place in position between outer uprights and secure.

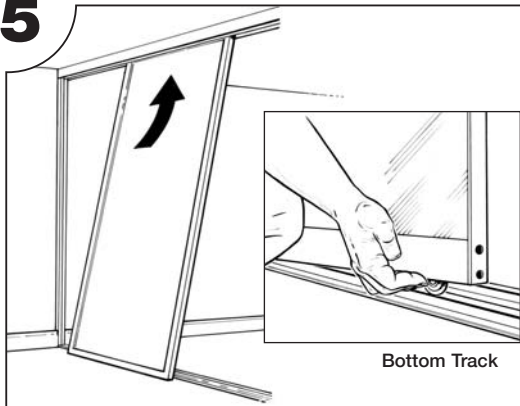
5

Bottom Track

INSTALLING DOORS

Tilt the door as shown and insert the top rail into the rear channel. Lift the bottom rollers(see illustration) into the rear groove of the bottom track. Take care not to scratch the bottom track. Repeat the process with the second door using the front channel and front bottom track.

For multidoor systems alternate doors on track.

6**VERTICAL ADJUSTMENT OF DOORS**

Use a allen key to raise or lower the roller via the access hole in the bottom of the door stile. Take load off wheels whilst adjusting.

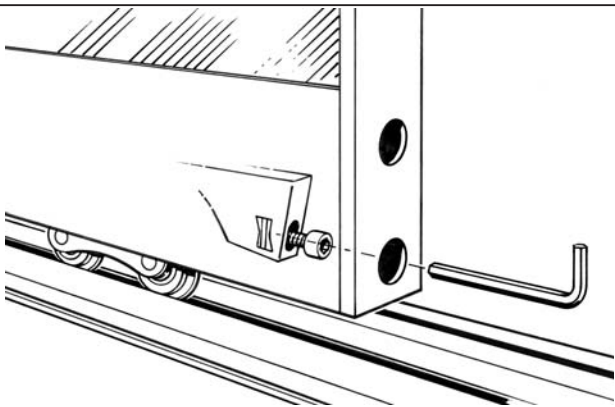



Pushing back the boundaries of space

Spaceslide Showrooms

Northgate, **Aldridge**, Walsall, West Midlands WS9 8TH
T: 01922 743211 - F: 01922 743513 - E: sales@spaceslide.co.uk

Drew House, Ebberrns Road, Apsley, **Hemel Hempstead**, Hertfordshire HP3 9QS
Retail: 01442 239900 - Trade: 01442 269963 / 252299 - F: 01442 244121 E: sales@spaceslide.co.uk

www.spaceslide.co.uk